

**IN THE MATTER OF AN APPLICATION
FOR THE REGISTRATION AS A TOWN OR VILLAGE GREEN
OF LAND AT STATION ROAD, NEWPORT**

**LIST OF APPENDICES
TO INSPECTOR'S REPORT**

Appendix A	Application Map (A9)
Appendix B	Objector's land areas plan
Appendix C	Applicant's Claimed Neighbourhood map (A40)
Appendix D	Registration Authority's map showing footpaths derived from definitive map (RA 171A)
Appendix E	Summary of user evidence questionnaires
Appendix F	Parties' analysis of activities claimed in evidence cards

**IN THE MATTER OF AN APPLICATION
FOR THE REGISTRATION AS A TOWN OR VILLAGE GREEN
OF LAND AT STATION ROAD, NEWPORT**

Appendix A to Inspector's Report

Application Map (A9)



Crown Copyright 2007. All rights reserved. Licence number 100020449
Location Plan
Scale: 1-2500

**IN THE MATTER OF AN APPLICATION
FOR THE REGISTRATION AS A TOWN OR VILLAGE GREEN
OF LAND AT STATION ROAD, NEWPORT**

Appendix B to Inspector's Report

Objector's land areas plan

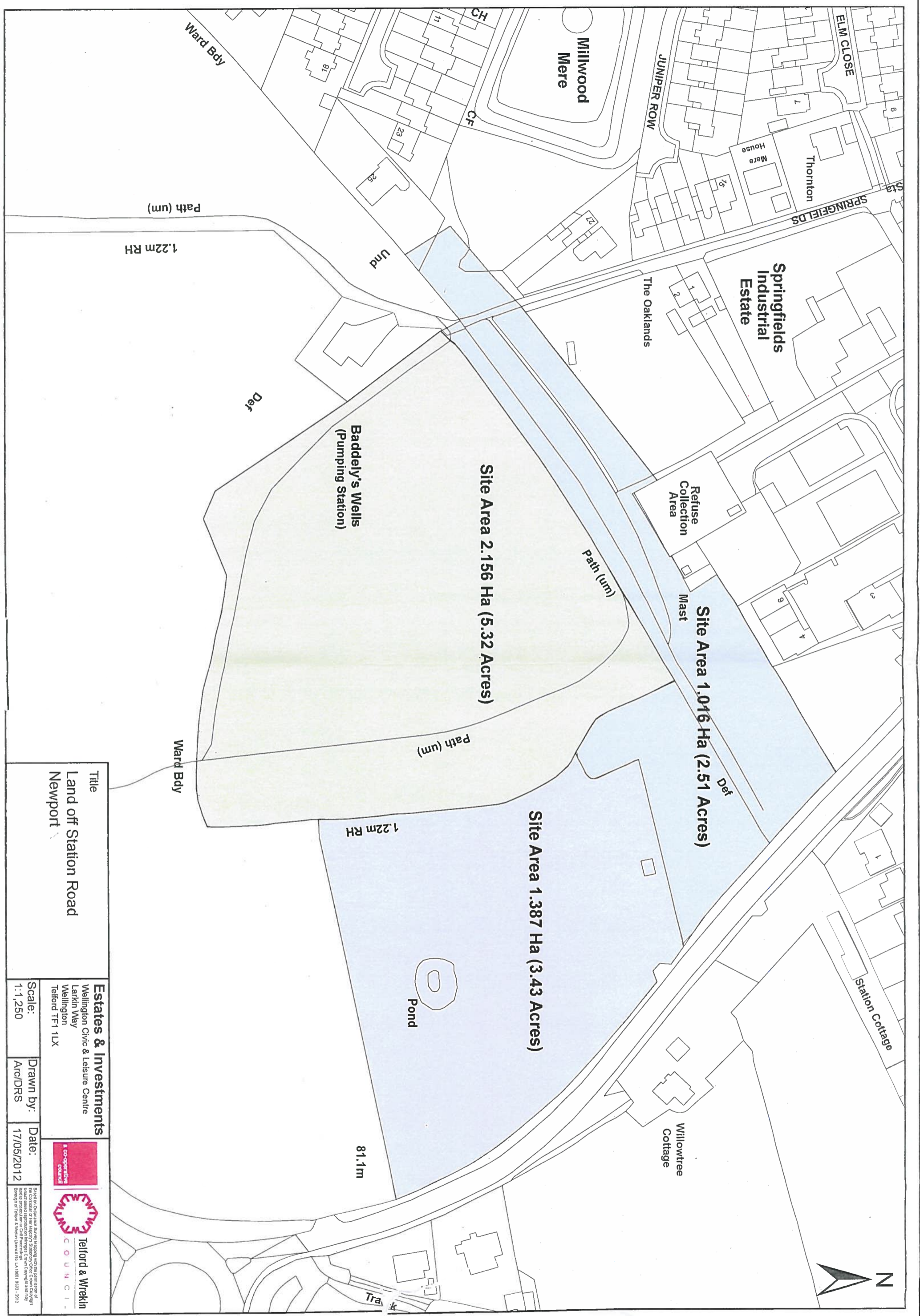

Title
Land off Station Road
Newport

Estates & Investments
Wellington Civic & Leisure Centre
Larkin Way
Wellington
Telford TF1 1LX

Telford & Wrekin
C O U N C I L
a co-operative council

Scale: 1:1,250
Drawn by: Arc/DRS
Date: 17/05/2012

Based on Ordnance Survey Mapping with the permission of the Controller of Her Majesty's Stationery Office. Crown Copyright. Material presented in this document is the property of Telford & Wrekin Council. Licence No. LA 1001 1802 - 2012

**IN THE MATTER OF AN APPLICATION
FOR THE REGISTRATION AS A TOWN OR VILLAGE GREEN
OF LAND AT STATION ROAD, NEWPORT**

Appendix C to Inspector's Report

Applicant's Claimed Neighbourhood map (A40)

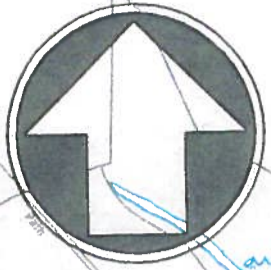



Summerhouse Farm

Strine Brook Park

754.8

NEWPORT

76.5m

NEWPORT



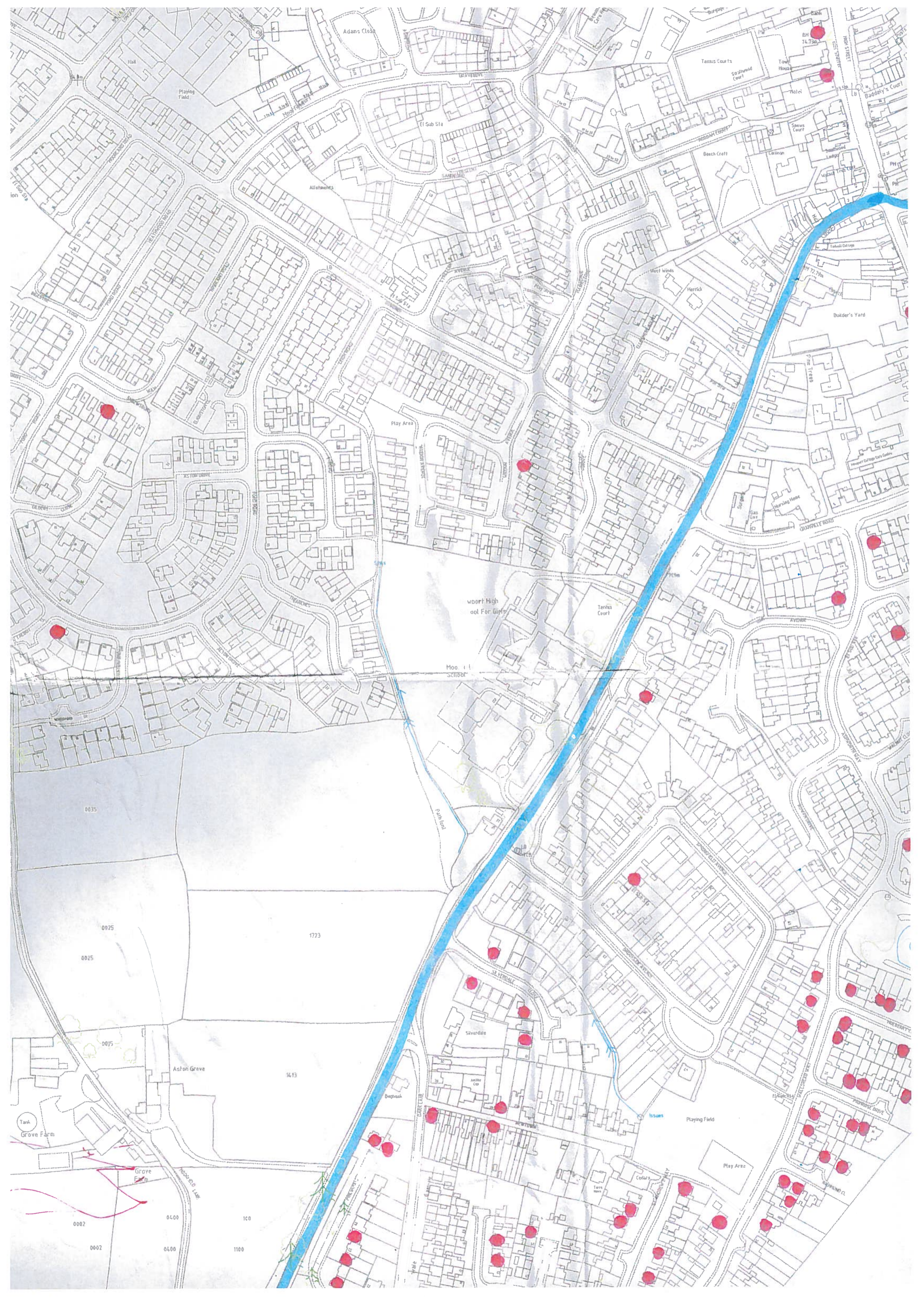

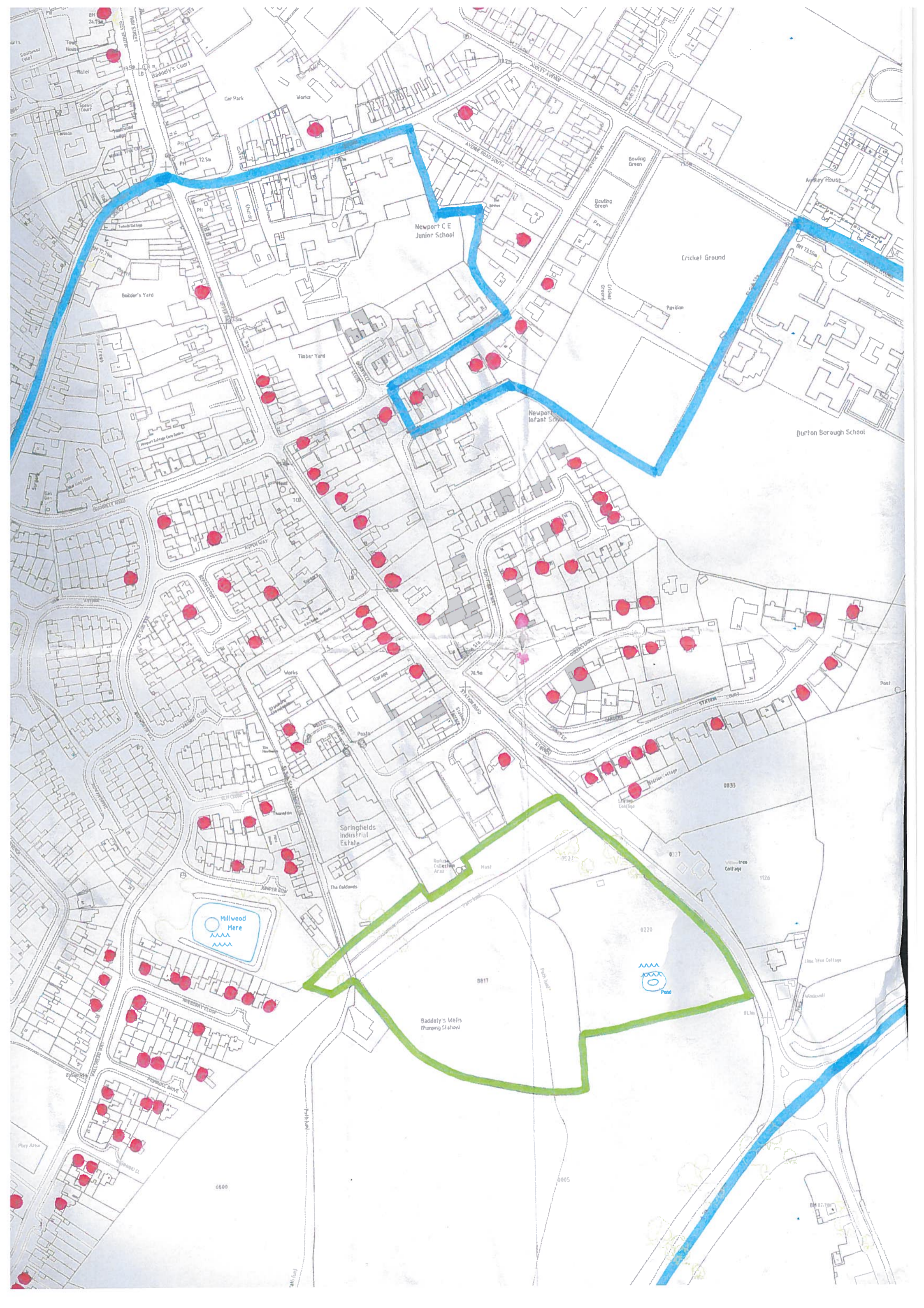



 VILLAGE GREEN
APPLICATION SITE

 NEIGHBOURHOOD

 SUPPORTERS OF
VILLAGE GREEN
APPLICATION

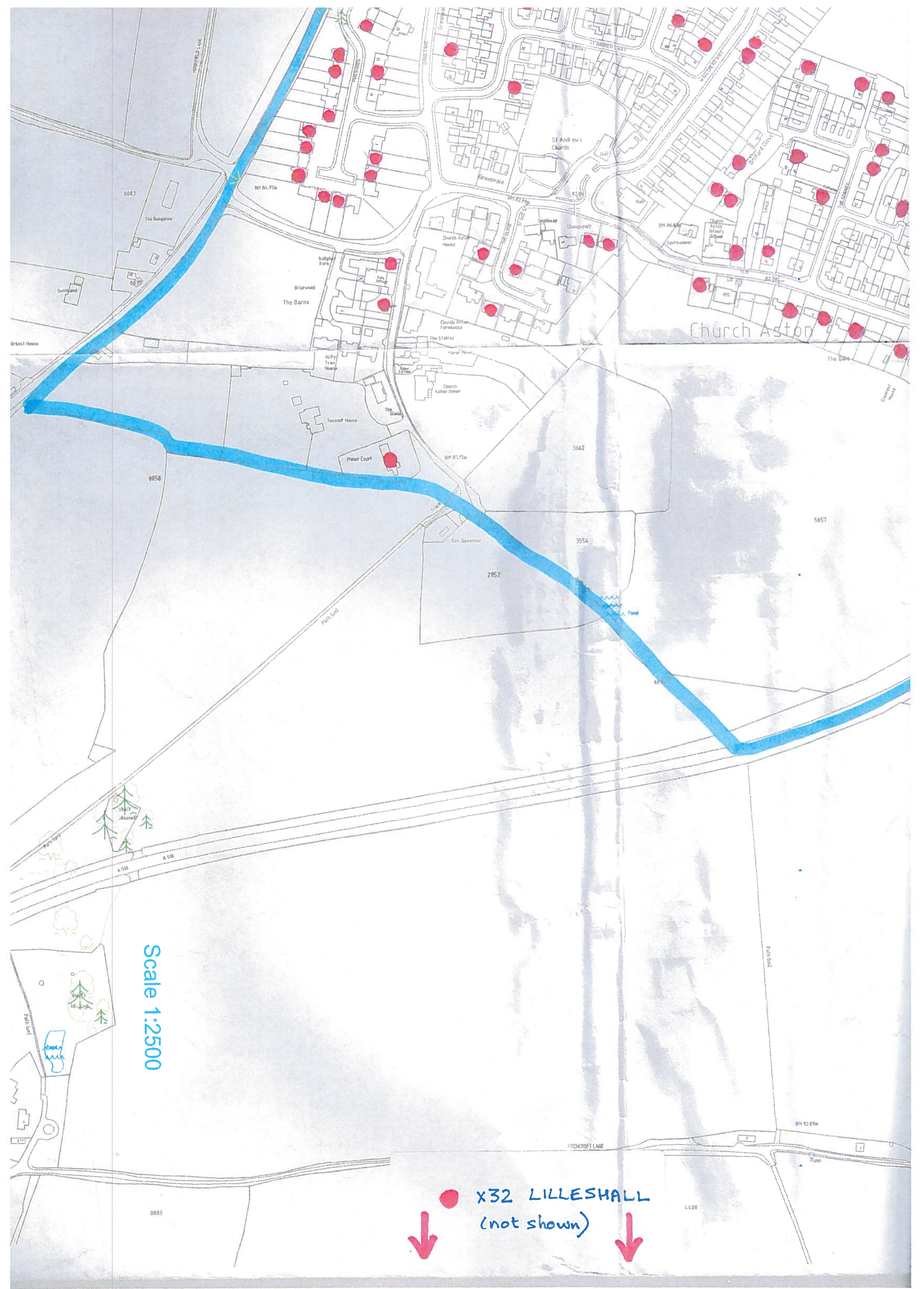

Scale 1:2500

● X32 LILLESHELL
(not shown)





**IN THE MATTER OF AN APPLICATION
FOR THE REGISTRATION AS A TOWN OR VILLAGE GREEN
OF LAND AT STATION ROAD, NEWPORT**

Appendix D to Inspector's Report

**Registration Authority's map showing footpaths derived from
definitive map (RA 171A)**

SJ 71

OUTLINE EDITION

ORDNANCE SURVEY

Scale 1:25,000 or about 2 1/2 Inches to 1 Mile

Provisional Edition

SHEET S

DEFINITIVE MAP
(There is no statement
available)

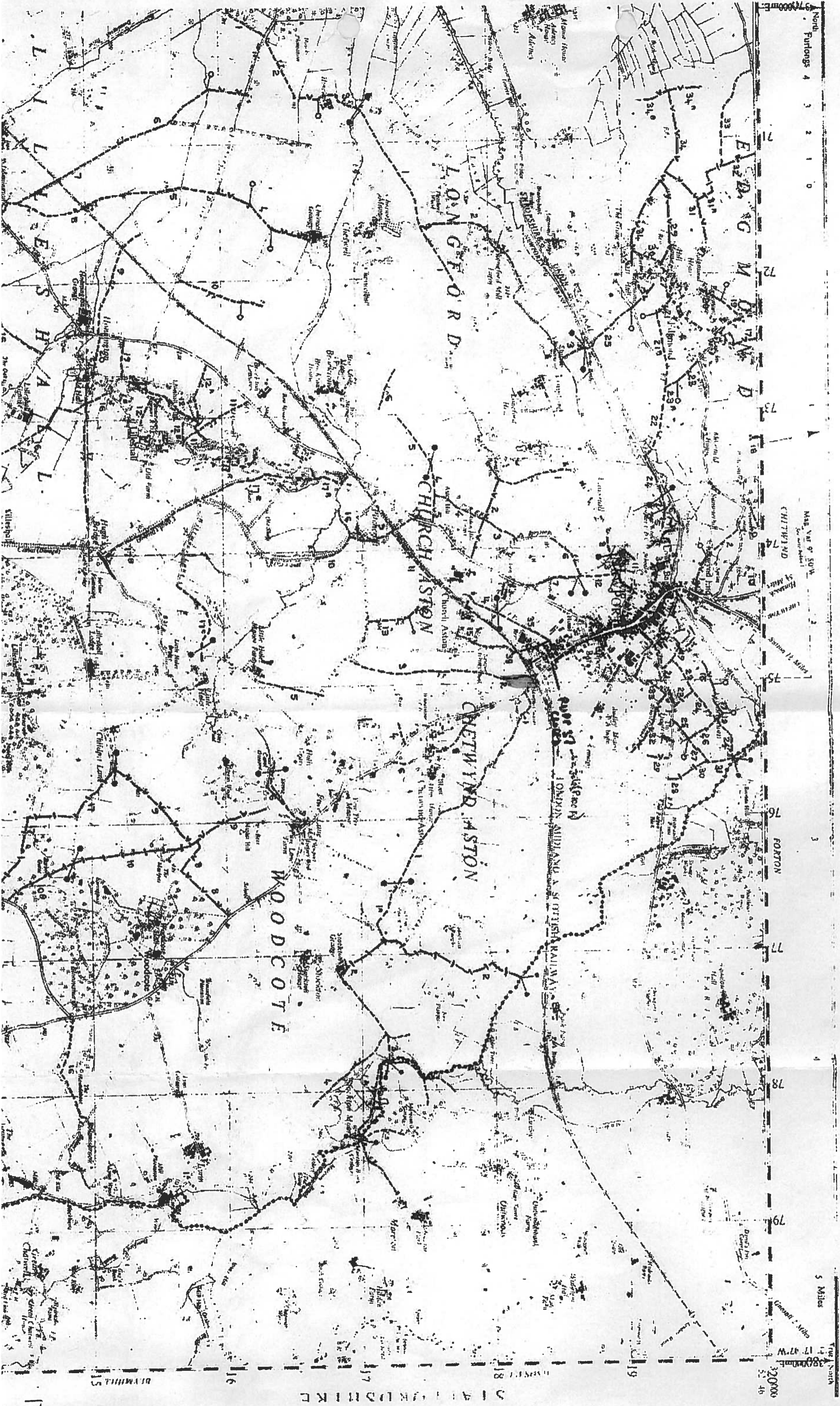

North
Furlongs 4 3 2 1 0

Mag. Var. 9° 50' N

CHITWIND
1/4 Mile

FORTON

5 Miles

320000
1:25000

15 16 17 18 19
17 18 19

**IN THE MATTER OF AN APPLICATION
FOR THE REGISTRATION AS A TOWN OR VILLAGE GREEN
OF LAND AT STATION ROAD, NEWPORT**

Appendix E to Inspector's Report

Summary of user evidence questionnaires

SUMMARY OF EVIDENCE QUESTIONNAIRES

(See Report paragraph 160)

Bundle page ref	Name	Address(es) when used land	Claimed period of user	Claimed activities
A359-364	Phillip Arrowsmith	16 Highfield, Church Aston, Newport	1982-2012	Use of footpath across field to walk to Newport/work/the Springfield Stores/the gym at Springfield Walks with grandson to show him the countryside
A365-366	Patricia Bain	13 Greenvale, Church Aston, Newport 22 The Larches, Newport	1995-2012	Observing buzzards Part of longer walks Short-cut from Station Road to Church Aston [Enjoying] natural beauty of area/peace and quiet
A367-368	Robert Bain	13 Greenvale, Church Aston, Newport 22 The Larches, Newport	1995-2012	Observing buzzards Part of longer walks Short-cut from Station Road to Church Aston [Enjoying] natural beauty of area/peace and quiet
A369-373	Christine & Derek Birch	The Willows, 28 Station Road & Sunnyside, Granville Avenue, Newport	1956-2012	Walking Bird watching Picking wild fruits in autumn Planting bulbs Clearing brambles, nettles, stones
A374-376	Gregg Brisco	2 Mulberry Close, Church Aston, Newport	2006-2012	Running Cycling Walking
A377-378	Caroline Buzzard	19 Chetwynd Aston, Newport	1997-2012	Walking Observing wildlife
A381-383	Amanda Crawshaw	9 Avenue Road, 6 Station Road,	2004-2012	Fresh air and exercise

		& 23 Station Road, Newport		Walking and talking with family Dog walking Chatting to neighbours Watching seasons change Experiencing quiet and nature
A385-389	Camilla Crawshaw	9 Avenue Road South, Newport	2004-2012	Dog walking Meeting friends Running Photography
A390-392	Paul Dawkins	16 Station Road, Newport	2008-2012	Walking Taking children in prams/pushchairs Children's play Taking photos Enjoying views and countryside
A393-396	M Farrell	9 The Folly, Church Aston, Newport	1991-2011	Dog walking
A403-405	Martin James	41 St Andrews Way	2002-2011	Walking through as part of walk round Church Aston Flying radio controlled aircraft
A406-408	James MacLauchlan	Highfield House, Church Aston, Newport	1994-2012	Walking (as part of local network of paths, access to Mere, access to Newport) Bird watching
A409	June Morris	10 Primrose Drive, Church Aston, Newport	1974-1984 1997-2012	Walking paths Blackberry picking Picnics and feeding horses when children were young
A410-412	Kenneth Reilly	3 Orchard Close, Church Aston, Newport	1975-1985 1992-2012	Walking Dog walking Taking children to play games/picnic (previously)
A413-417	Wilma Robertson	1 Primrose Drive, Church Aston	1986-2011	Walking and socialising dogs Learning about local affairs Picking fruit Learning how different crops grow

A419-421	Daphne Rogers	12 Westfield Terrace & 20 Station Road, Newport	1963-2012	Rounders, camping and bike riding in youth Walking dogs Picking blackberries and sloes
A422-425	J B Taylor	9 Juniper Row, Newport	1976-2012	Walking Running Fruit picking
A426-428	Ian Thomas	8 Silverdale Close, Church Aston, Newport	1990-2012	Walking Exercise on the public footpaths
A429-432	W & J Titley	52 Church Aston, Newport	1972-2012	Used with/by children/grandchildren for cycling, playing, kite flying, den making, tree climbing Walking
A433-434	Simon Tracey	5 Princess Gardens, Newport	2001-2012	Dog walking Cycling Bird watching Butterfly spotting Kite flying
A435-439	John & Ina Walker	36 Oak Avenue & 9 Pen-y-Bryn Way, Newport	1974-2012	Dog walking Wildlife watching Meeting neighbours
A440-441	Janet Welton	6 Primrose Drive, Church Aston, Newport	1976-2012	Exercising dogs Walking and playing with children/grandchildren Collecting butterflies etc for school projects Visiting horses Picnics when fallow
A442-444	Justin Williams	9 Upper Bar, Newport	2009-2012	Dog walking Children playing Start of circular walks round Lilleshall Circular running route Kite flying after harvest

**IN THE MATTER OF AN APPLICATION
FOR THE REGISTRATION AS A TOWN OR VILLAGE GREEN
OF LAND AT STATION ROAD, NEWPORT**

Appendix F to Inspector's Report

Parties' analysis of activities claimed in evidence cards

Activity	Number of Households ¹ (Subject)	Number of Households ¹ (Applicant)
Walking	216	202
Dog Walking	122	121
Flora/fauna/bird/wildlife watching	81	100 ²
Cycling	59	55
Photography	42	42
Fruit Picking	41	38
Running	40	45
Playing/playing with children	27	32
Picnicking	19	18
Socialising	19	20
Kite flying	12	12
Feeding/watching horses	6	6
Ball Games	6	6
Planting	5	5
Rambling	4	4
Horse Riding	3	3
Leisure	3	3
Frisbee	2	2
Model Aircraft Flying	1	1
Brownies	1	2 ³
Orienteering	1	2
Sledging	1	1
Geocaching	1	1
Astronomy	1	1
Charity Fundraising	1	1
Golf	1	1
Sketching	1	1
Sitting	1	1
Bonfires	1	1

¹ N.b. The count does not include the final column in the table in the bundle, where respondents gave details of the activities they had seen others carrying out on the land.

² N.b. Bird watching has been counted separately from viewing wildlife/flora/fauna as it is often mentioned as a separate activity by respondents. This accounts for the difference in figures between the Applicant and Respondent.

³ Includes one reference to scouts.