

NEW SHED FOR ALUMINIUM : PLAN

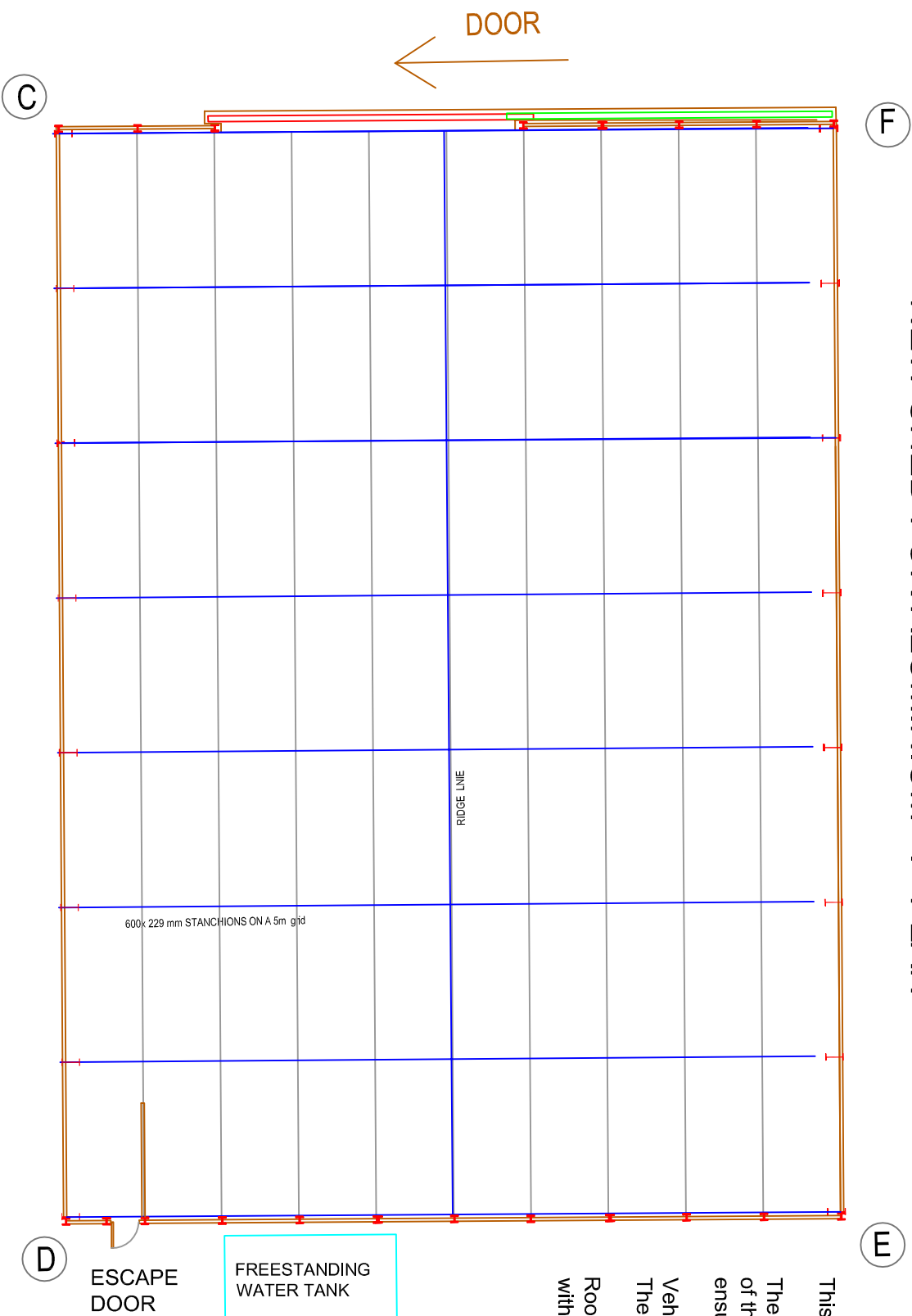

This new building is an acoustic shed for the handling of aluminium scrap

The construction is a conventional portal frame steel building but the specification of the cladding, the roof and the doors is to a particular acoustic specification to ensure that the building acts as an acoustic enclosure.

Vehicles will be backed into the building through the door in the north-west elevation. The door will be shut whilst the unloading or loading takes place.

Roof drainage to be into freestanding water tank (used for dust suppression system) with overflow into existing yard drainage via interceptor at location shown.



SOUTHWEST - NORTHEAST SECTION

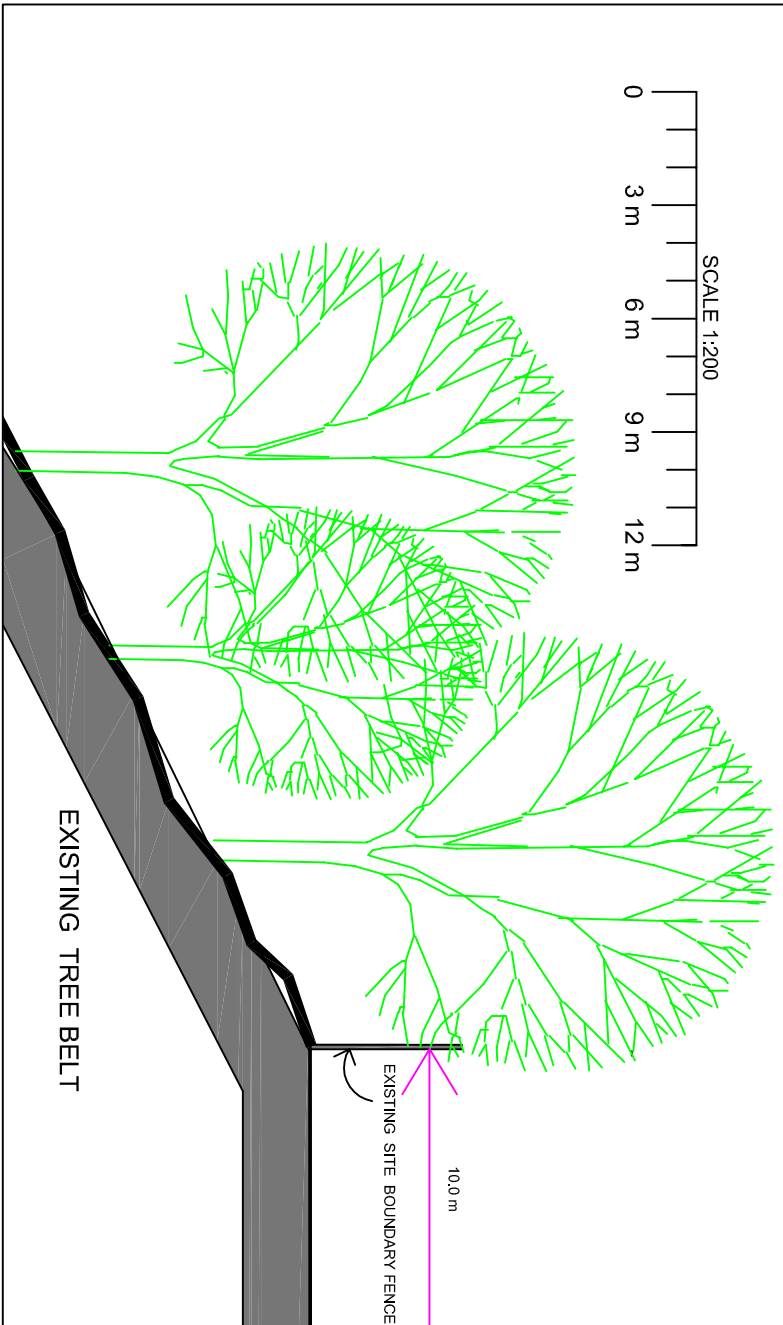
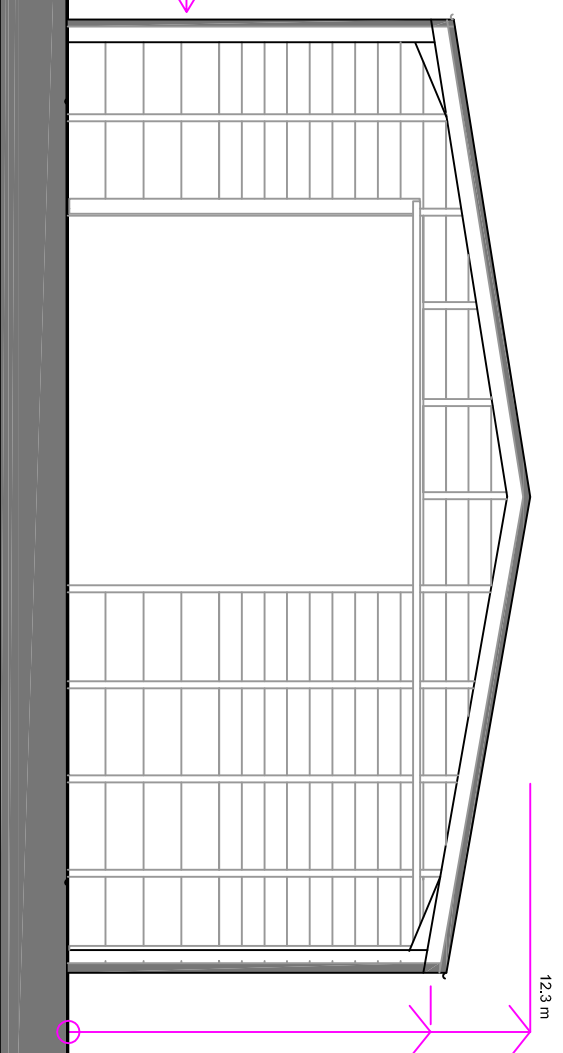

METAL AND WASTE RECYCLING LTD SITE AT LIGHTMOOR RD TELFORD TF4 3QN NEW BUILDING	
14/03/14	A3 @ 1:200
J 248 T2 07 rev A	
CHRIS DENT ARCHITECT 5 NORTH AVENUE EXETER EX1 2DU Telephone 01392 435434 mail@ChrisDentPlanning.co.uk	