

NOTE:
COLUMN CAPABILITY TO SUPPORT THE PROPOSED EQUIPMENT WILL BE CONFIRMED BY A MANUFACTURERS GDC, AND FOUNDATION SIZES CONFIRMED ACCORDINGLY.

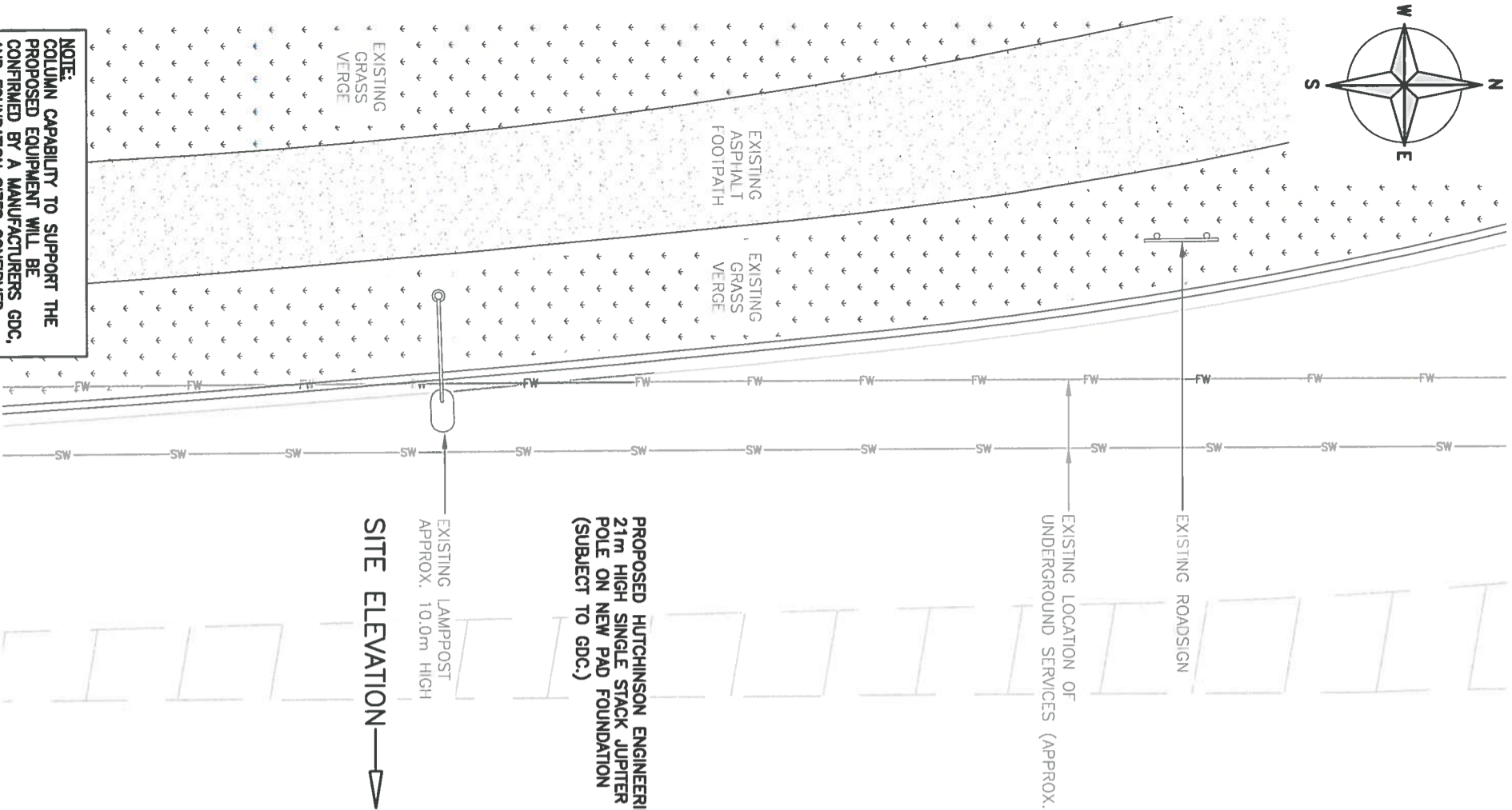

OLD PARK WAY

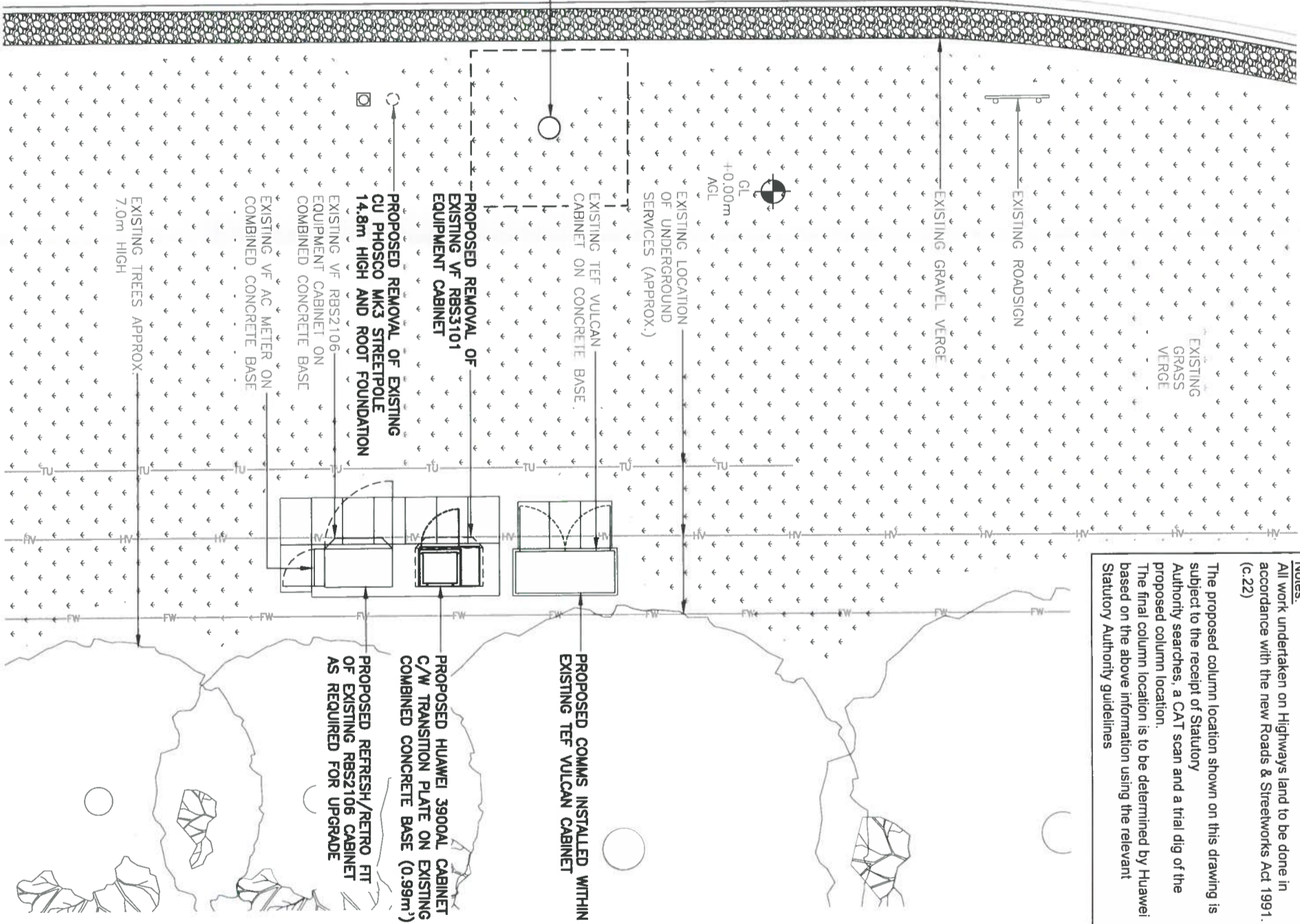

PROPOSED SITE PLAN

(1:100)

5000

0

5000

10000

ORIGINAL SCALE AT A3 - 1:100

ALL DIMENSIONS IN MILLIMETRES

Notes:
All work undertaken on Highways land to be done in accordance with the new Roads & Streetworks Act 1991. (c.22)

The proposed column location shown on this drawing is subject to the receipt of Statutory Authority searches, a CAT scan and a trial dig of the proposed column location.
The final column location is to be determined by Huawei based on the above information using the relevant Statutory Authority guidelines

ALL DIMENSIONS ARE IN mm UNLESS NOTED OTHERWISE

N.G.R E: 368801 N: 309761

CONCESSION REQUIRED YES

EXISTING U/G SERVICES KEY

- HW POWER LINE HV
- LV POWER LINE LV
- E POWER LINE UNIDENTIFIED
- GLD GAS LOW PRESSURE
- GMP GAS MEDIUM PRESSURE
- GHP GAS HIGH PRESSURE
- PW POTABLE WATER
- FW FOUL SEWER
- CSEW COMBINED SEWER
- SW SURFACE WATER SEWER
- TU TELECOM
- CA CABLE
- EA ABANDONED PIPE
- UNIDENTIFIED

22 MAY 2015

RECEIVED

BOROUGH OF TELFORD & WREKIN
ENVIRONMENT & REGENERATION

REV	MODIFICATION	BY	CH	DATE
B	Pole/foundation amended	PCH	JT	22.04.15
A	Issued for Approval	DI	JT	31.03.15



HUAWEI



vodafone
CTIL - BEACON

Cell Name	Cell ID No	Opt.
LAND ADJACENT TO ROUNDABOUT		
CTIL	VF	TEF
124742	08816	047691

Site Address / Contact Details

OLD PARK WAY
TELFORD
SHROPSHIRE
TF3 5DA

Drawing Title: PROPOSED SITE PLAN

Purpose of Issue: PLANNING

Drawing Number: 201

Drawn	Date	Checked	Date	Issue
DI	31.03.15	JT	31.03.15	B

The drawings comply with CTIL Beacon Non-Standard ICNIRP guidelines.
Designed in accordance with CTIL Beacon documents: SDN0008 & SDN0009 'ICNIRP Compliance Summary'