

Proposed Layout

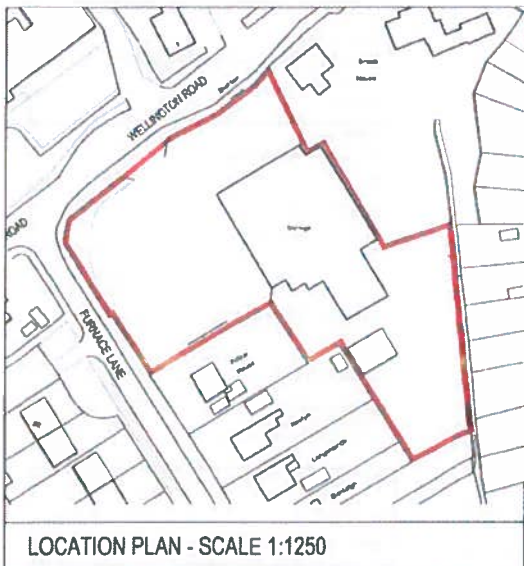
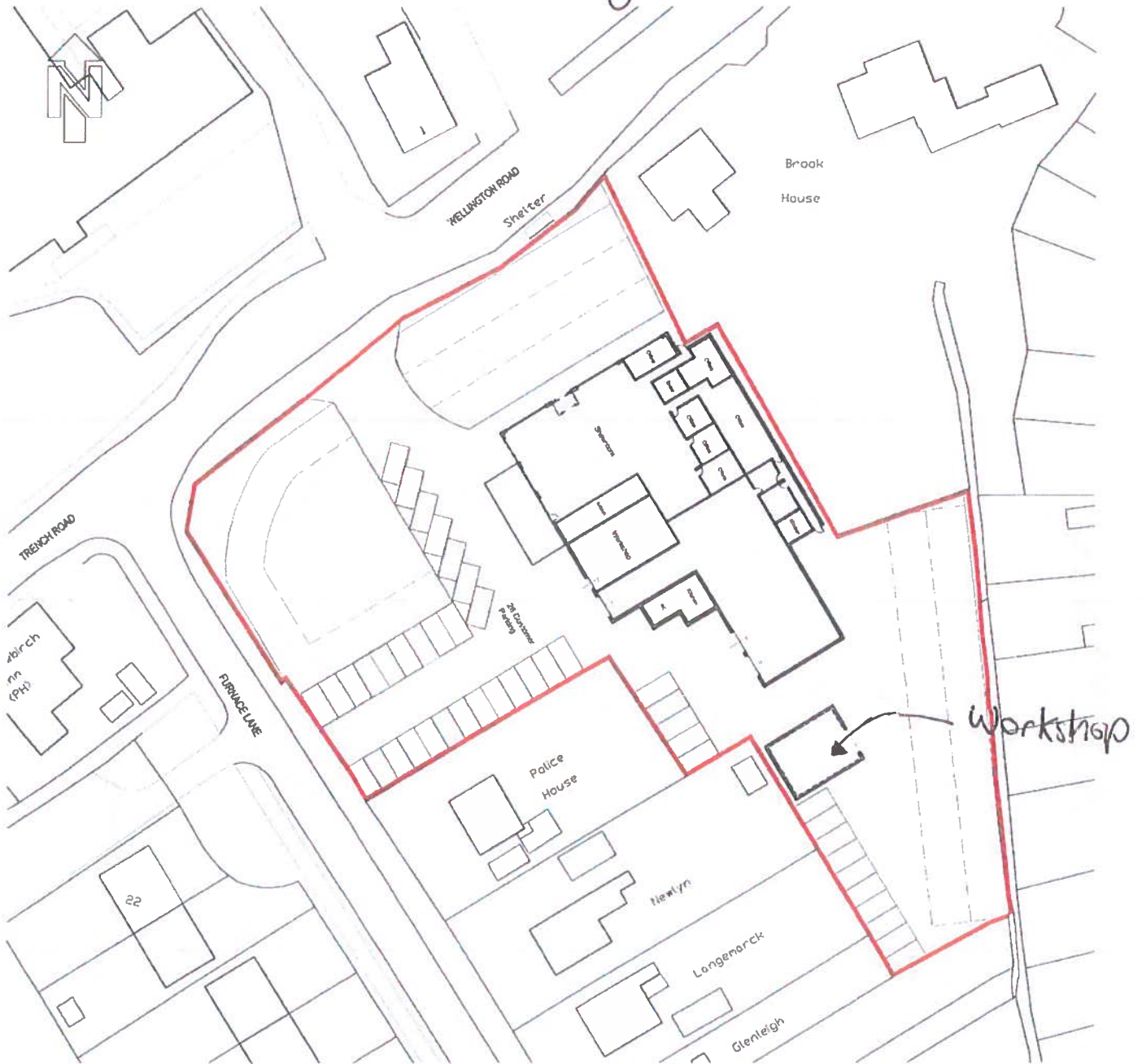

NOTES:

The copyright © of this drawing is vested in the Architect and must not be copied or reproduced without consent.

All Contractors must visit the site and be responsible for taking and checking dimensions relative to their work. Sutton and Wilkinson Chartered Architects to be advised of any variation between drawings and site conditions.

DO NOT SCALE OFF THIS DRAWING. IF IN DOUBT ASK

Ordnance Survey (©) Crown Copyright 2011. All rights reserved. Licence number 100020449

The Wrekin Housing Trust

PROJECT:
Change Of Use
Inchcape Vehicle Dealership and Workshop
Trench Road
Telford

CLIENT:
The Wrekin Housing Trust

TITLE:
PROPOSED SITE PLAN
& LOCATION PLAN

SUTTON AND WILKINSON
CHARTERED ARCHITECTS

Victoria House, 13 New Pentridge Road,
Cannock, Staffs, WS11 1HW

Telephone: 01543 466441
Facsimile: 01543 462499
e-mail: office@suttonwilkinson.co.uk



SCALE 1:500, 1:250	DRAWN AJC / AMB	DATE Jan '13	SIZE A3
DRAWING NUMBER 2274 - 02			REVISION