

2 Typical Section thro New building
1 : 100

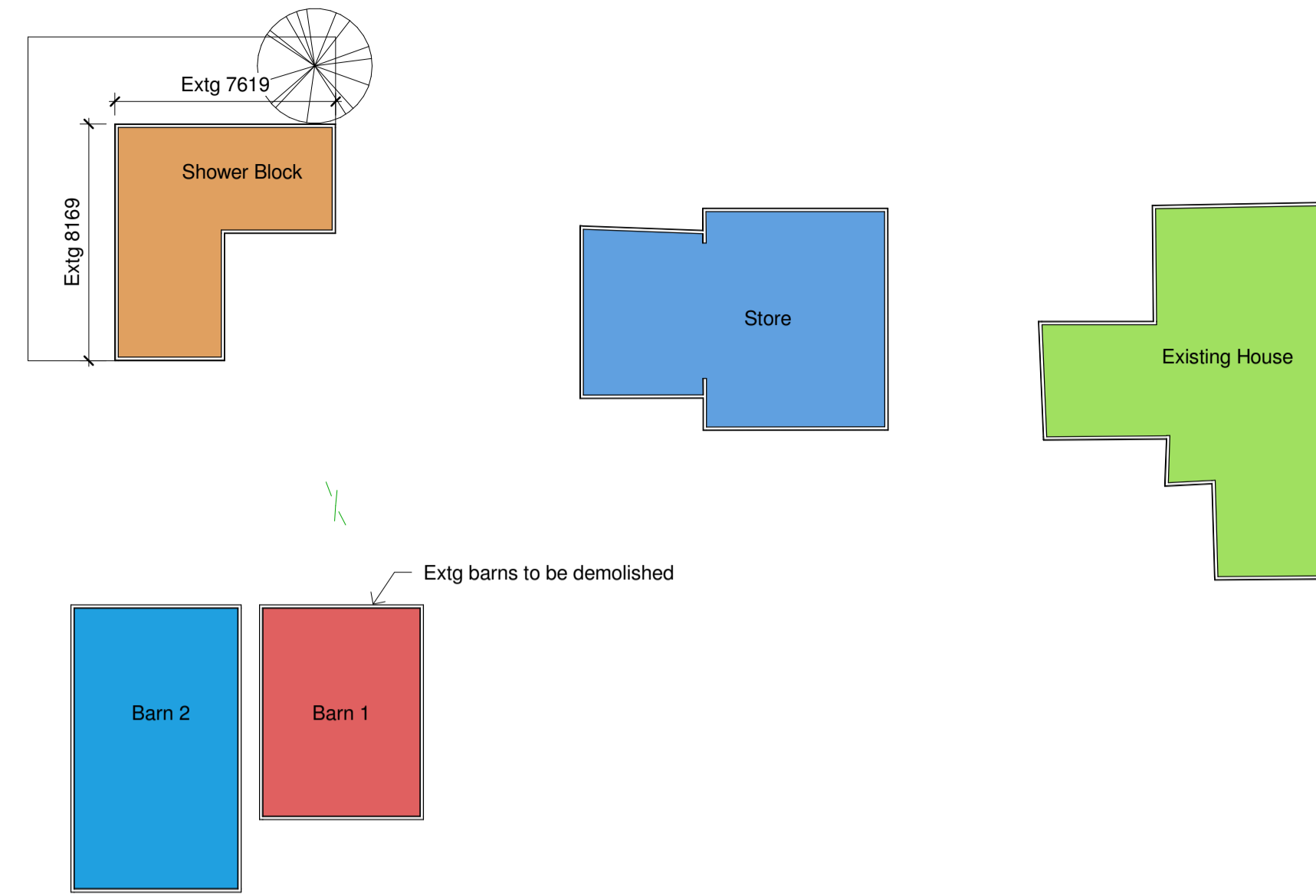

3 Level B - Ground Existing
1 : 200

This Drawing is a Copyright of **CRONIN DEVELOPMENT CONSULTANCY LIMITED**. Do Not Scale from this Drawing. Use figured dimensions ONLY. If in doubt ASK! ALL dimensions to be checked on site before work commences. ANY discrepancies are to be reported immediately. This drawing to be read in conjunction with all Project and Consultants Performance Specifications, Structural / Civil Engineers drawings / calculations, and any Specialist Sub-Contractors Designed Element drawings.

Room Schedule	
Name	Area
Shower Block	42 m ²
Classroom 6	26 m ²
Classroom 5 & Seminar Room	57 m ²
Classroom 4	35 m ²
Classroom 3	33 m ²
Classroom 2	25 m ²
Classroom 1	26 m ²
Store	70 m ²
Existing House	80 m ²

Rev	Date	Description	Issued by
B	21/10/15	PLANNING APPLICATION	AJC
A	05/10/15	Preliminary Issue for Comment, drawings resized to A1	AJC

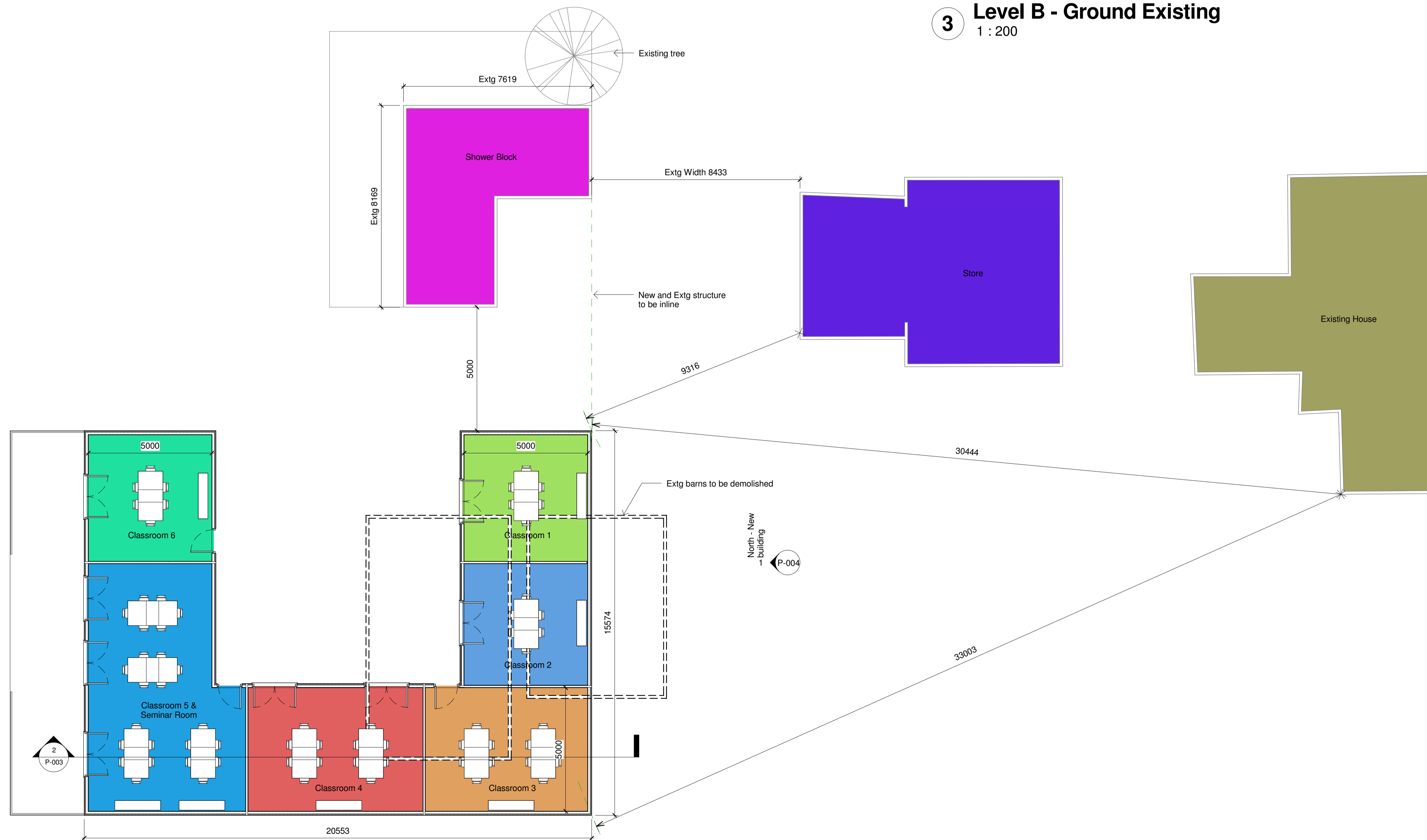

1 Level B - Ground Proposed
1 : 100



Cronin Development Consultancy Limited
53 Springfield Crescent, Walmley, Sutton Coldfield,
West Midlands, B76 2SS
t: 0121 240 7730 m: 07957 465624
e: andy.cronin@cronindc.co.uk

PROJECT
**Wellbeck Villa,
Pickstock**

TITLE
Proposed Block Plan

CLIENT
Mr D Eggerton

STATUS PLANNING APPLICATION		
DRAWN BY AJC	CHECKED BY AJC	DATE 05/17/15
SCALE (@ A1) As indicated		PROJECT NUMBER A131
DRAWING NUMBER P-003	REV B	