

Drawing Continued on MMD-357450-0700-SK-XX-0010

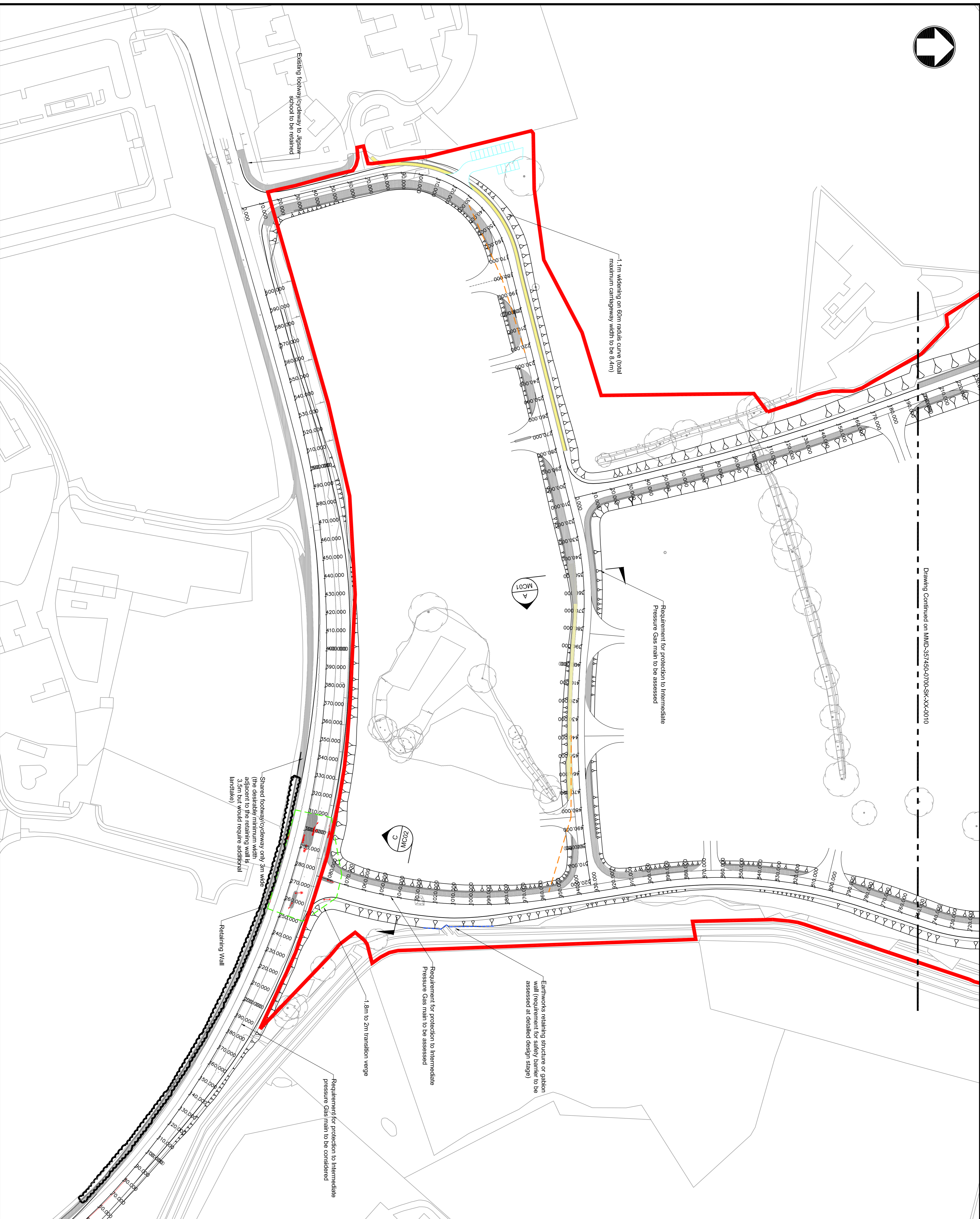

- Notes
- All dimensions are in metres unless otherwise stated. All levels are shown in metres above ordnance datum.
 - Do not scale any items or information from this drawing.
 - Site Boundary is taken from 14-087-PQ12_P7.
 - 50m visibility achieved at junctions with 4.5m set back.
 - Bellmouths designed to achieve a 43m visibility with 2.3m setback.
 - Vertical road alignment to be reviewed on completion of drainage strategy.
 - Bainmouth Construction to terminate at plot boundaries Materplan to ensure that plot boundaries are not less than 1m from edge of earthworks batters to provide space for filter drains and junction widening on curves
 - Design of access road and 20m bellmouth radii compliant with swept path design vehicle; FTA design articulated vehicle (1398t) 16.48m, 15m Bellmouth radii compliant with 8m LGV Box panel van.

- Key to symbols
- Bellmouth Visibility Splay (Not all shown)
 - Junction Intervisibility Zone
 - Primary Signal Head
 - Secondary Signal Head
 - Proposed shared footway/ cycleway
 - Proposed footway
 - Site Boundary
 - Proposed Earthworks
 - Retaining Structure
 - Proposed Jigsaw School
 - Car park and solar farm access
 - Approximate extent of proposed retaining wall at the back of footway/cycleway

- Reference drawings
- Topographic Survey 16896 - 22/10/15
 - Highway Layout GA (Sheet 2 of 2)
 - MMD-357450-SK-0700-XX-0010
 - MMD-357450-0700-SK-XX-0011 - MC01 and MC02 Cross Sections

Rev	Date	JK	Preliminary Issue	RB	KC
P1	11.02.16	JK			
			Description	Chk'd	App'd

35 Newhall Street
Birmingham
B3 3PQ
T: +44 (0)121 234 1500
W: www.mottmac.com

Telford & Wrekin
C O U N C I L

Client
Telford and Wrekin Council
Estates and Investments
Wellington Civic & Leisure Cen.
Larkin Way Wellington,
Telford. TF1 1LX

Title
Land at Hortonwood West Infrastructure
Highway Layout
General Arrangement
(Sheet 1 of 2)

Scale at A1	Status	Rev	Sec'd
1:1000	PRE	P1	STD

Drawing Number
MMD-357450-0700-SK-XX-0009

© Mott MacDonald Limited
This document is issued for the party which commissioned it and for specific purposes connected with the captioned project only. It should not be relied upon by any other party or used for any other purpose. We accept no responsibility for the consequences of this document being relied upon by any other party, or being used for any other purpose, or containing any error or omission which is due to an error or omission in data supplied to us by other parties.

Reproduced from the Ordnance Survey base map with permission of the Controller of Her Majesty's Stationery Office. Crown Copyright Licence No. 0100015245. Unauthorised reproduction infringes Crown Copyright and may lead to prosecution or Civil Proceedings.