



Camera 01: Street 1 & 1a junction looking north



Camera 02: Street 2a buildings facing peregrine way. looking east



Camera 03: Street 2 street 3 junction. looking east



Camera 04: Junction street 2 street 3 looking south



Camera 05: Street 3 street 4 junction looking southwest



Camera 06: Street 4 street 5 junction looking north



Camera 07: Street 6 looking north



Camera 08: Peregrine way looking northeast



Camera 09: Street 1c looking west

Responsibility is not accepted for errors made by others in scaling from this drawing. All construction information should be taken from figured dimensions only.

0mm 50mm 100mm

A1 Original Sheet Size

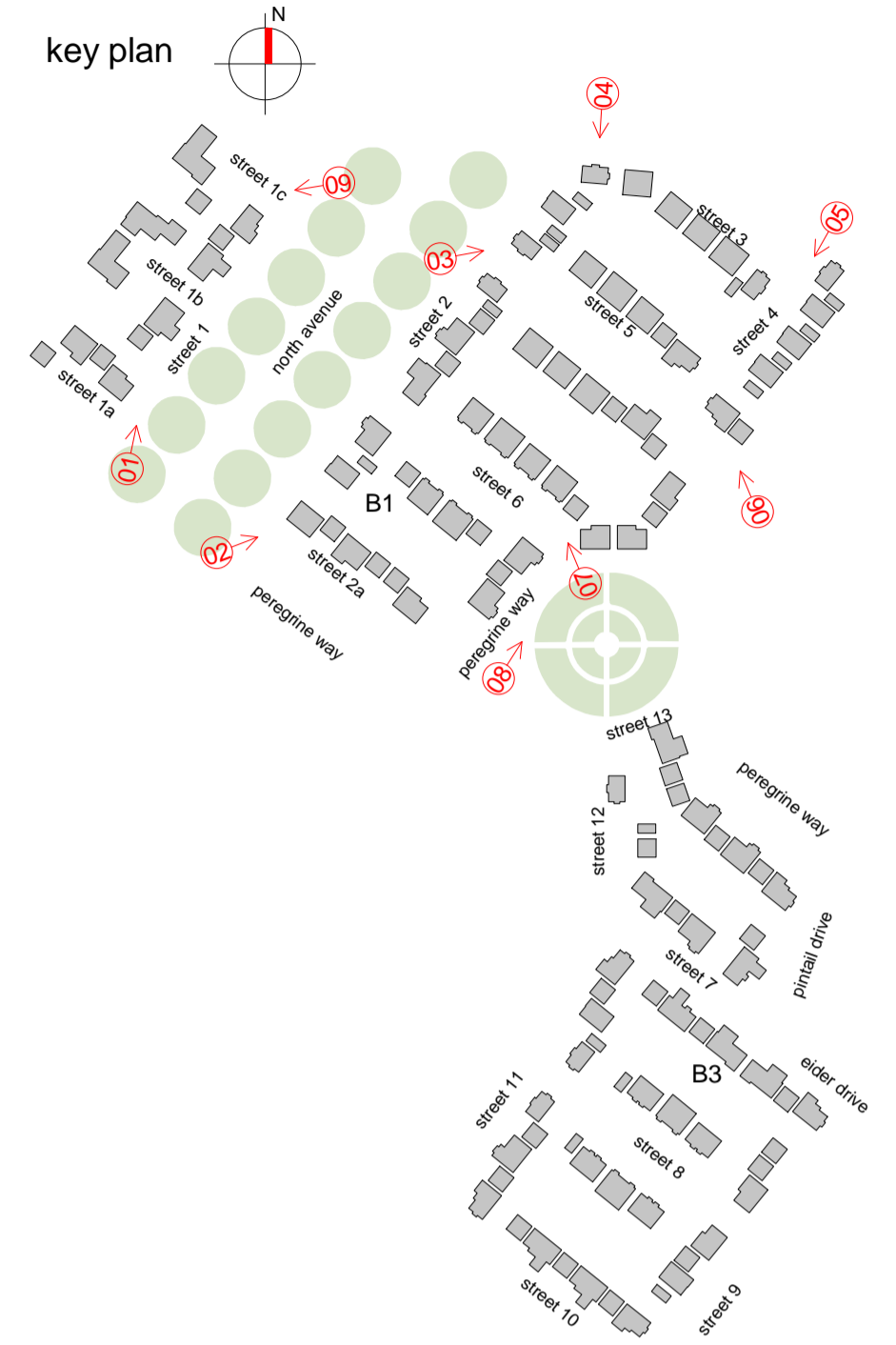

colours for illustrative purposes only  
some trees omitted for clarity

date	rev	name	chk	note

© Stride Treglown Limited 2015.

**Stride Treglown**

Architecture Town Planning Interior Design Building Surveying Landscape Design Graphic Design  
3 Cosser Street, London, SE1 7BU  
T 020 7401 0700 F 020 7401 0701 www.stridetreglown.co.uk

PROJECT  
Sites B1 and B3 Apley Telford.

DRAWING TITLE  
3D street views sheet 01

STATUS  
planning issue

SCALE	DATE	DRAWN BY	CHECKED BY
@A1	09/01/2017	tn	ml
PROJECT NUMBER	DRAWING NUMBER	REVISION	
22077	P(0)_070		