



Camera 10: Peregrine way looking south



Camera 11: Junction peregrine way & pintail drive looking west



Camera 12: Junction eider drive & street 9 looking southwest



Camera 13: Street 8 looking northwest



Camera 14: Street 8 looking south



Camera 15: Street 12 looking southeast



Camera 16: Junction street 11 street 7



Camera 17: Street 11 looking east



Camera 18: Street 10 looking north

Responsibility is not accepted for errors made by others in scaling from this drawing. All construction information should be taken from figured dimensions only.

0mm 50mm 100mm

A1 Original Sheet Size

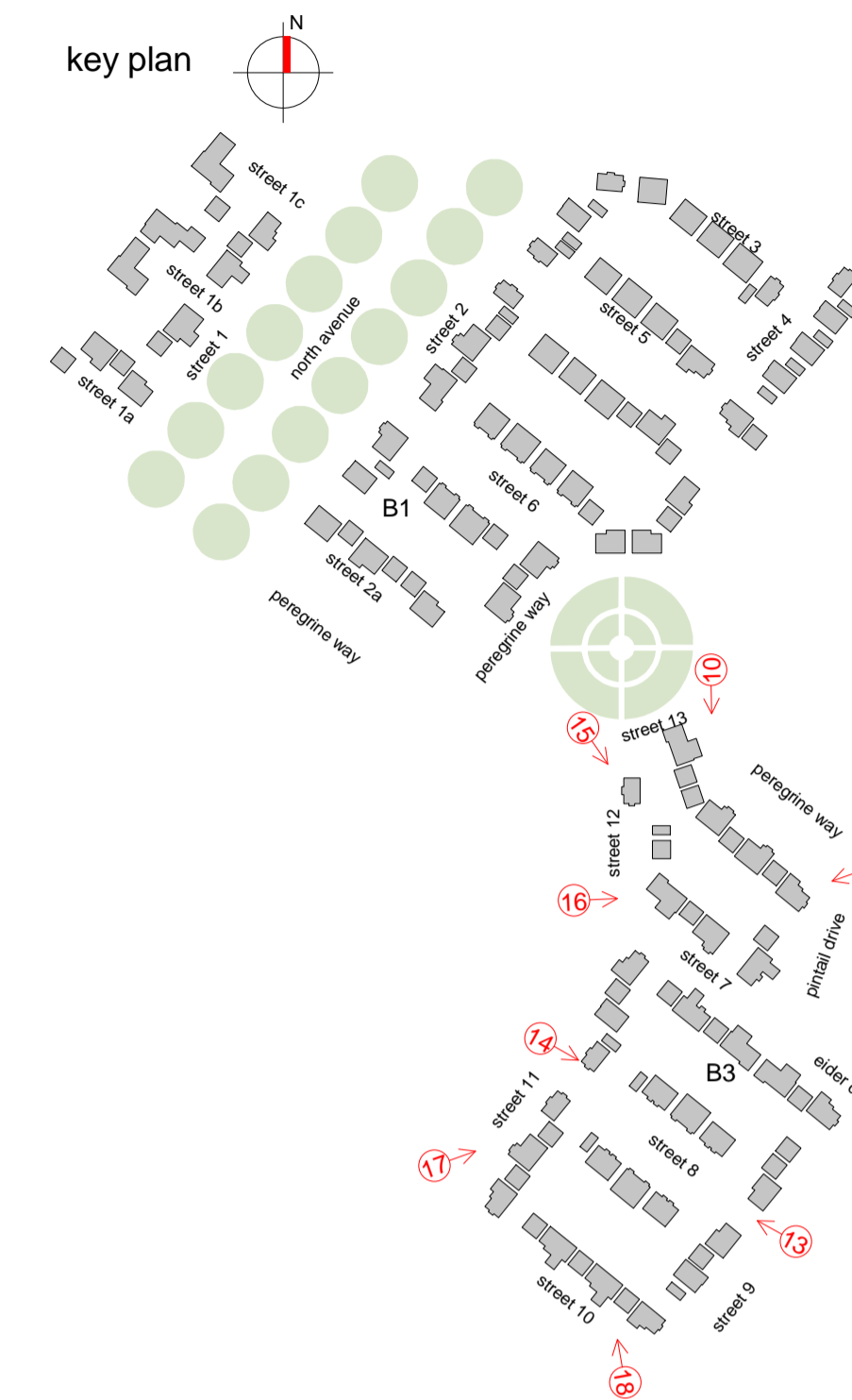

colours for illustrative purposes only  
some trees omitted for clarity

date	rev	name	chk	note

© Stride Treglown Limited 2015.

**Stride Treglown**

Architecture Town Planning Interior Design Building Surveying Landscape Design Graphic Design  
3 Cosser Street, London, SE1 7BU  
T 020 7401 0700 F 020 7401 0701 www.stridetreglown.co.uk

PROJECT  
Sites B1 and B3 Apley Telford.

DRAWING TITLE  
3D street views sheet 02

STATUS  
planning issue

SCALE DATE DRAWN BY CHECKED BY  
nts @A1 09/01/2017 tn ml

PROJECT NUMBER DRAWING NUMBER REVISION  
22077 P(0)\_071