

TREE PROTECTION NOTES:
 'Trees in relation to design demolition and construction' BS5837:2012

1.0 PRIOR TO COMMENCEMENT OF WORKS:

1.1 PRIOR TO COMMENCEMENT: all trees that are being retained onsite shall be protected by barriers and / or ground protection before any materials or machinery are brought onto the site, and before any demolition, development or stripping of soil commences. The 'Root Protection Area' (RPA) associated with existing trees designated for retention shall be protected from damage by erection of scaffold framework barriers in accordance BS 5837:2012 Figure 2 including where specified appropriate ground protection.

1.2 EXTENT OF ROOT PROTECTION AREA (RPA): as shown on the Tree Protection Plan (TPP) the RPA is generally to be in accordance with Annex D, Table D.1 'Root Protection Area' - as an area equivalent to a circle radius 12 times the stem diameter (single stem trees) or based on the combined stem diameter for multistem trees (trees with more than one stem arising below 1.5m above ground level) refer to Clause 4.6.

1.3 TREE PROTECTION BARRIER: a vertical and horizontal scaffold framework well braced to resist impacts as illustrated below (refer to Figure 2 of BS5837:2012). The vertical tubes should be spaced at a maximum interval of 3 metres and driven securely into the ground. Care should be taken to avoid underground services and contact with structural roots. In the presence of underground services, retained hard surfacing or where special circumstances dictate an alternative specification as illustrated in Figure 3 of BS5837:2012 may be acceptable subject to agreement with the project arboriculturalist and the local planning authority.

All weather site notices should be attached to the barrier with words such as 'CONSTRUCTION EXCLUSION ZONE - NO ACCESS'. Once installed barriers and ground protection shall not be removed or altered without prior approval of the project arboriculturalist and where necessary approval from the local planning authority.

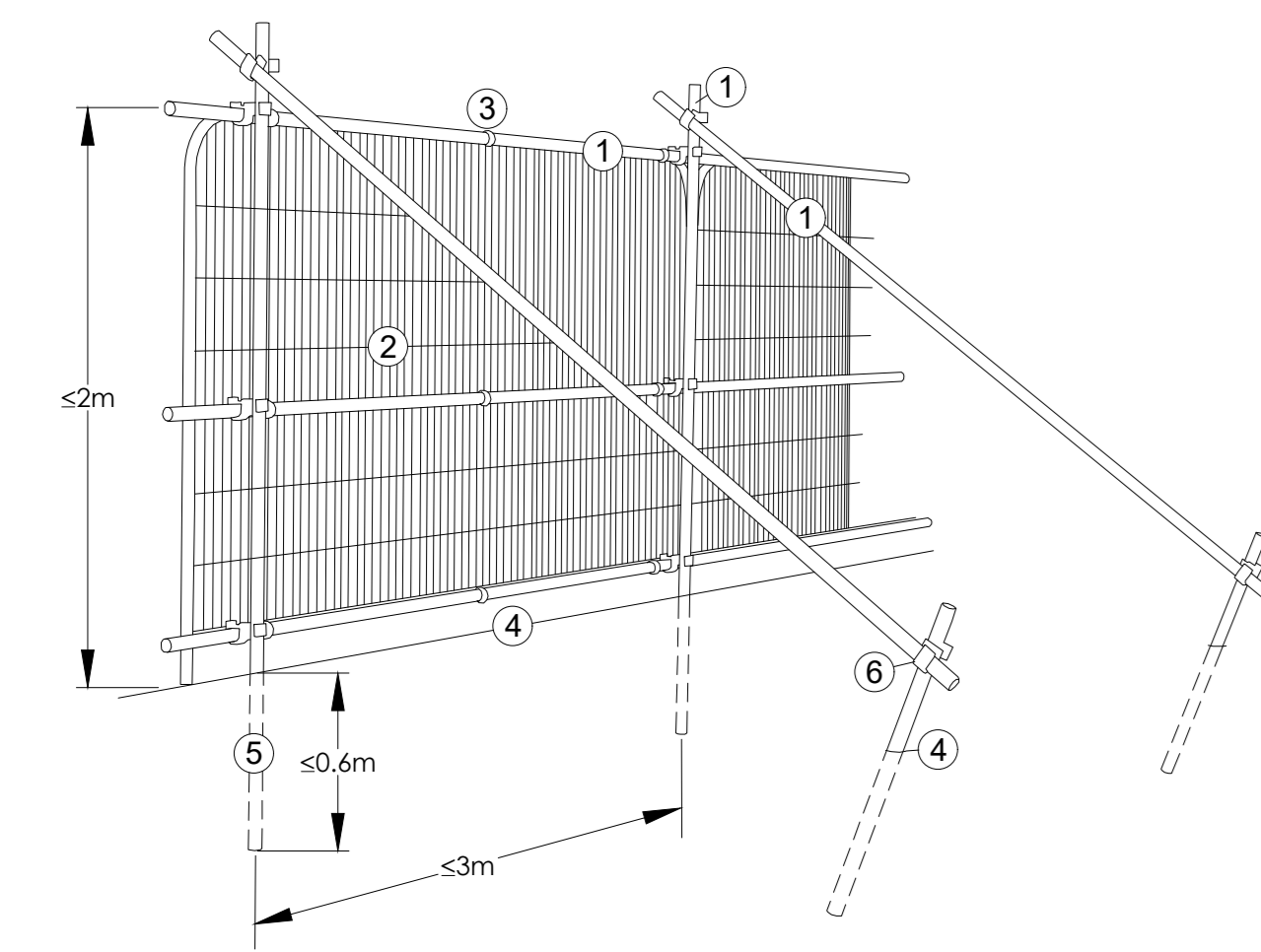

1. Standard scaffold poles
2. Heavy gauge 2m tall galvanised tube and weld mesh infill panels
3. Panels secured to uprights and cross members with wire ties
4. Ground Level
5. Uprights driven into ground until secure (minimum depth 0.6m)
6. Standard scaffold clamps

2.0 ADDITIONAL PRECAUTIONS:

2.1 Planning of site operations should take sufficient account of wide or tall loads, or plant with booms, jibs or counterweights (including drilling & piling rigs) in order that they can operate without coming into contact with retained tree. The transit or traverse of plant in proximity to trees shall be conducted under supervision of a banksman to ensure adequate clearance from trees is maintained at all times. Access facilitation pruning as agreed with the project arboriculturalist and/or local authority should be undertaken where necessary to maintain clearance. NB Works to trees protected by a Tree Preservation Order or within a Conservation Area will need approval by the local authority.

2.2 Any materials whose accidental spillage would cause damage to a tree should be stored and handled well away from the outer edge of its RPA e.g. concrete mixings, diesel oil and vehicle washings. Allowances shall be made for sloping ground to avoid damaging materials running towards retained trees.

2.3 Fires on sites should be avoided. Where they are unavoidable, they should not be lit in a position where heat could affect foliage or branches. The potential size of a fire and wind direction should be taken into account when determining its location, and should be attended at all times until safe to leave.

2.4 Trees are not to be used as anchorages for equipment, or for other purposes. Notice boards, telephone cables, or other services should not be attached to any part of the tree.

2.5 The dumping of spoil or rubbish, placing of temporary accommodation and storage of materials within the root protection area is prohibited.

2.6 The change of ground level, excavating, stripping or disturbing topsoil within the RPA is prohibited.

3.0 GROUND PROTECTION DURING DEMOLITION & CONSTRUCTION

3.1 Where construction working space or temporary construction access is specified within the RPA, this should be facilitated by a set-back in the alignment of the tree protection barrier. In such areas, suitable existing hard surfacing that is not proposed for re-use as part of the finished design should be retained to act as temporary ground protection during construction, rather than being removed during demolition. The suitability of such surfacing for this purpose should be evaluated by the project arboriculturalist and an engineer as appropriate.

3.2 Where the set-back of the tree protection barrier exposes unmade ground to construction damage, new temporary ground protection should be installed as part of the implementation of physical tree protection measures prior to work starting on site.

3.3 New temporary ground protection should be capable of supporting any traffic entering or using the site without being distorted or causing compaction of underlying soil, for example:

- a) for pedestrian movements only, a single thickness of scaffold boards placed either on top of a driven scaffold frame, so as to form a suspended walkway, or on top of a compression-resistant layer (e.g. 100 mm depth of woodchip), laid onto a geotextile membrane;
- b) for pedestrian-operated plant up to a gross weight of 2 t, proprietary, inter-linked ground protection boards placed on top of a compression-resistant layer (e.g. 150 mm depth of woodchip), laid onto a geotextile membrane;
- c) for wheeled or tracked construction traffic exceeding 2 t gross weight, an alternative system (e.g. proprietary systems or pre-cast reinforced concrete slabs) to an engineering specification designed in conjunction with arboricultural advice, to accommodate the likely loading to which it will be subjected. If necessary sand should be laid on the ground as a compressible layer.

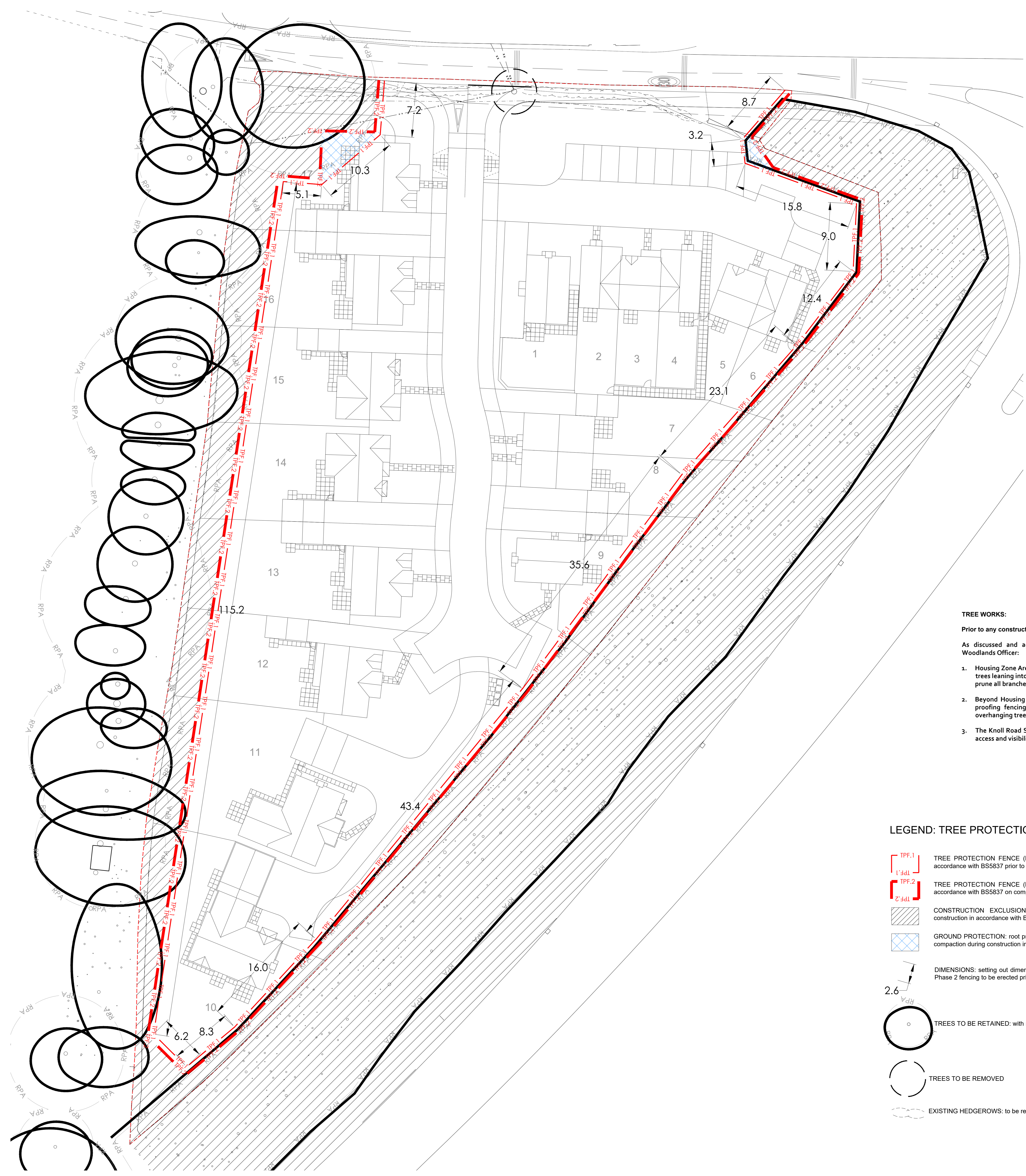

- TREE WORKS:**
- Prior to any construction works**
- As discussed and agreed Telford Town Council's Trees and Woodlands Officer:
1. Housing Zone Area - Fell edge of development screen trees & trees leaning into site and as part of woodland management, prune all branches back where necessary.
 2. Beyond Housing Zone for access for future acoustic sound proofing fencing - Target prune back to fencing line all overhanging trees and vegetation.
 3. The Knoll Road Side - Fell all trees and hedging for new site access and visibility, fell two dead trees as part of work zone

LEGEND: TREE PROTECTION TO BS 5837:2012

- TREE PROTECTION FENCE (PHASE 01): to be constructed in accordance with BS5837 prior to commencement.
- TREE PROTECTION FENCE (PHASE 02): to be constructed in accordance with BS5837 on completion on Phase 01 works.
- CONSTRUCTION EXCLUSION ZONE: to be protected from construction in accordance with BS5837.
- GROUND PROTECTION: root protection area to be protected from compaction during construction in accordance with BS5837.
- DIMENSIONS: setting out dimensions from the existing fence line. Phase 2 fencing to be erected prior to removal of Phase 01 fencing.
- TREES TO BE RETAINED: with root protection zone illustrated.
- TREES TO BE REMOVED
- EXISTING HEDGEROWS: to be removed to facilitate development

This drawing and the design it depicts are copyright and may not be copied or reproduced without written permission from Bea Landscape Design Ltd. No liability will be accepted for amendments made by others. This drawing is to be read in conjunction with the landscape specification and other relevant drawings.

Contains Ordnance Survey Data © Crown Copyright and Database Right 2015. © Crown Copyright. All Rights reserved 100018739.

Do not scale from this drawing. Figured dimensions only to be used. Refer any query to office of originator.

rev	date	amendments:	alt:
A	10.02.2016	to co-ord with revised layout	DP
B	06.10.2016	to co-ord with revised layout	DP



client:
Cameron Homes Ltd

project:
The Knoll
Church Aston

title:
Tree Protection Plan

status:
PLANNING

date: Feb 2016	drawn: DP	number: 16-004-02
scale@A0: 1:200	checked: TGW	revision: B

Bea Landscape Design Ltd
132A The Workhouse, Coopers
Road, Wolverhampton, WV1 1QB
T: 01902 424 950 / 01902 451 901
E: info@bealandscape.co.uk
www.bealandscape.co.uk