

# SCHEDULE OF ACCOMMODATION

Hotel	4 Accessible rooms 31 Family rooms 33 Standard rooms 68 Bedrooms
Retail Unit	323 sq m 3,475 sq ft

© This drawing/disk and the works depicted are the copyright of Design Development Partnership Ltd and may not be reproduced or amended except by written permission. No liability will be accepted for amendments made by other persons.

All drawings and specification to be read in conjunction with Structural Engineer and other consultants drawings; all discrepancies should be reported to the architect.

Figured dimensions only are to be taken from this drawing

- Preliminary     Comment     Planning
- Tender     Construction     Record
- Legal

### Drawing Revisions

Rev	Description	Date
A	Pedestrian Ramp omitted	08/03/16
B	Accommodation revised	16/03/16
C	Service access revised	22/03/16
D	Floor plans revised	01/04/16
E	Event space added	13/04/16
F	Dimensions added to event space	03/05/16
G	Floor plans revised	13/05/16
H	Floor plans revised to standard bedrooms	23/05/16
J	Lobby added to ground floor linen	24/05/16
K	Accommodation revised	25/05/16
L	Site paving amended	03/06/16
M	Structural columns amended	11/07/16
N	Schedule of accommodation revised	20/07/16
P	Glazing to south elevation revised	27/07/16
Q	Red line amended	19/08/16
R	Sub-station added	09/09/16
S	Sub-station relocated	19/09/16
T	Cycle parking added	08/11/16

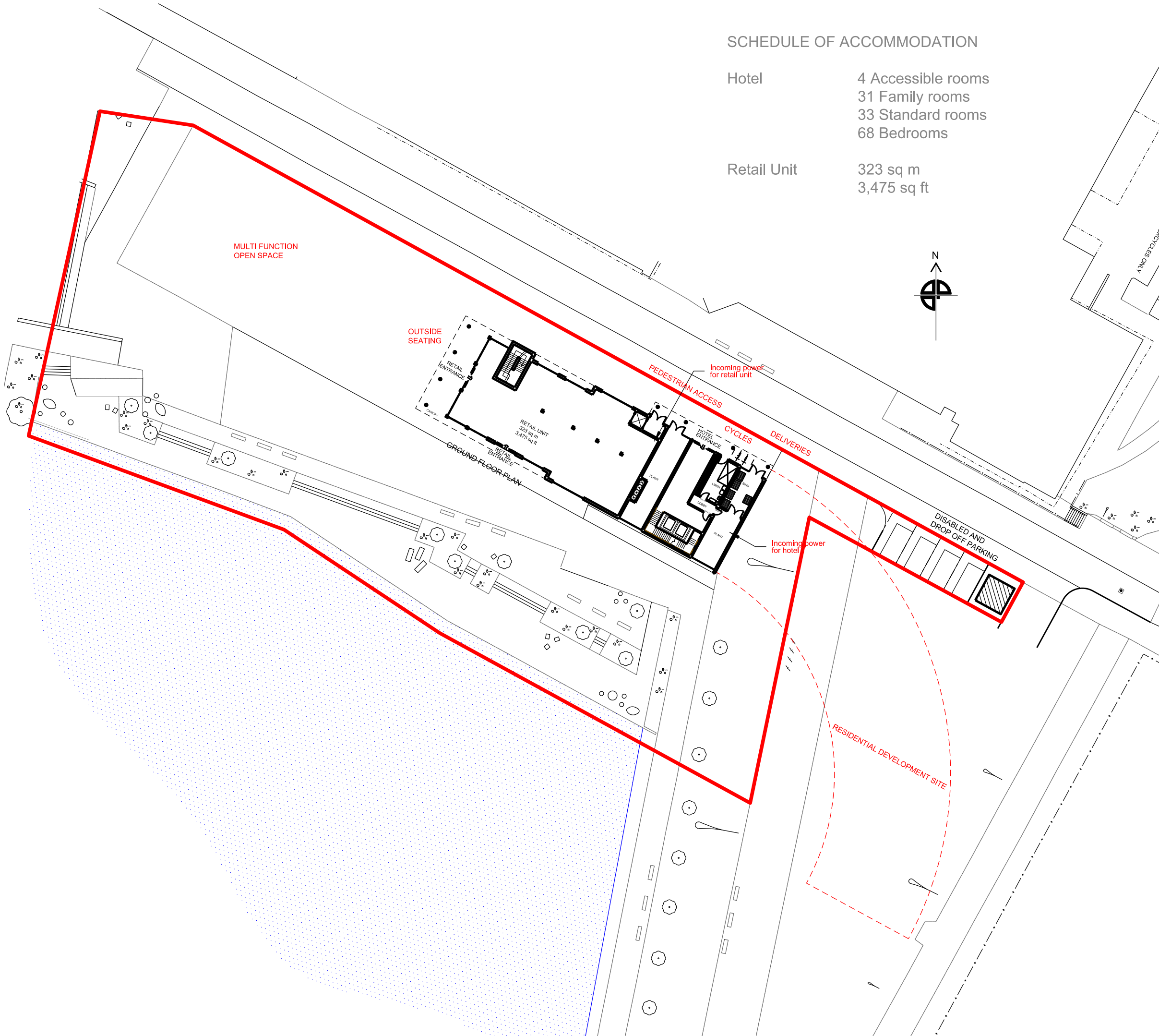

CLIENT HINTON PROPERTIES

PROJECT SOUTHWATER TELFORD

TITLE Proposed Hotel and Retail Unit Site Plan

SCALE @ A3 1:500    DATE 07/03/2016

DRAWING 185 - 02    REV T

DRAWN BY DW    CHECKED BY



ARCHITECTURE + PLANNING + PRINCIPAL DESIGNER

A: Reims House, 8 The Croft, Buntsford Drive, Bromsgrove, B60 4JE  
 T: 01527 571 765  
 F: 01527 878 207  
 E: mail@ddpdesign.co.uk  
 W: www.hintongroup.co.uk