

© this drawing and the building works depicted are the copyright of idp and may not be reproduced or amended except by written permission. no liability will be accepted for amendments made by other persons.

all dimensions to be checked on site and architect notified of any discrepancies prior to commencement.
do not scale.

notes:

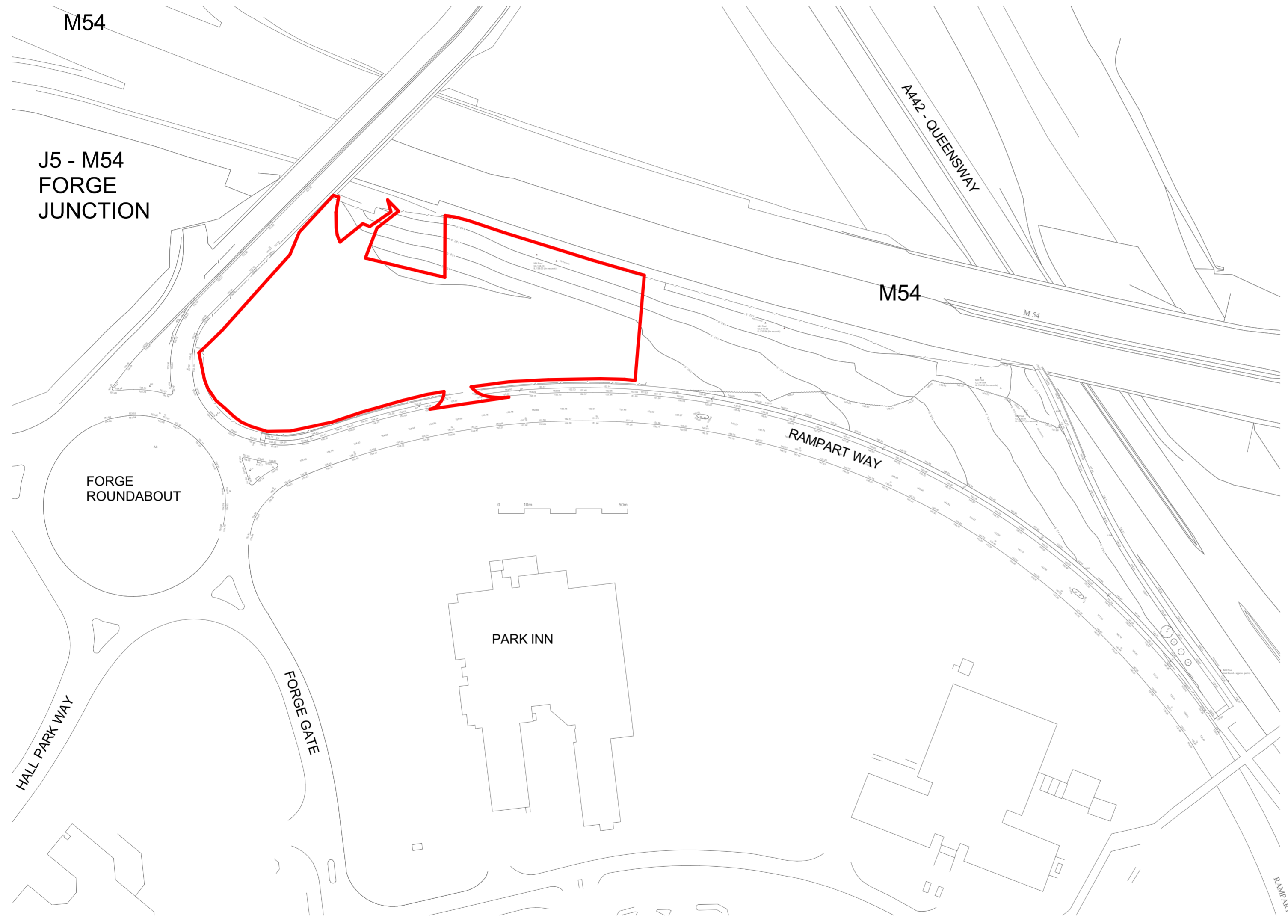
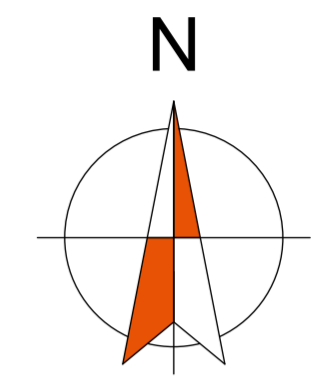

B	08.09.17	Updated to LA validation comments	PES	PES
A	17.01.17	Drawing status updated to Planning.	SOS	PES
rev:	date:	comment(s):	name:	check:

IDP ARCHITECTS.
URBAN DESIGNERS.
PLANNERS.
PROJECT MANAGERS.
LANDSCAPE ARCHITECTS.
WE ARE IDP.

status: **PLANNING** RIBA Stage: **3**

client: **Telford Commercial Ltd**

job: **Rampart Way, Telford**

title: **Location Plan**

drawn: **PES** date: **04.10.16**

checked: **PES** scale @ a2: **1:1250**

job no: **C2595** drg no: **000_00 Rev B**

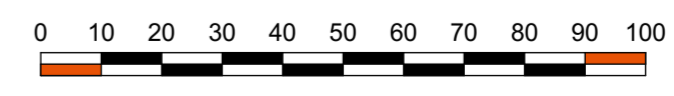

IDP GROUP 27 SPON STREET COVENTRY CV1 3BA
T: +44 (0)24 7652 7600 E: info@idpgroup.com
www.weareidp.com