

PLANTING SCHEDULE

Native Screening Woodland Mix A				Total Area (m ²):	2540	■
Quantities	Species Name	Common Name	Height	General Specification		Percentage
127	Acer campestre	Common Maple	250-300cm	Feathered: 3 brks: 2x: B		7.5
85	Betula pendula	Common Silver Birch	250-300cm	Feathered: 3 brks: 2x: B		5
127	Carpinus betulus	Common Hornbeam	100-125cm	1+2: Transplant - seed raised: B		7.5
127	Cornus sanguinea	Common Dogwood	60-80cm	1+1: Transplant - seed raised: Branched: 3 brks: B		7.5
127	Corylus avellana	Common Hazel	80-100cm	1+2: Transplant - seed raised: Branched: 4 brks: B		7.5
169	Crataegus monogyna	Common Hawthorn	100-125cm	1+2: Transplant - seed raised: B		10
85	Prunus avium	Wild Cherry	250-300cm	Feathered: 3 brks: 2x: B		5
169	Prunus spinosa	Blackthorn	100-125cm	1+2: Transplant - seed raised: Branched: 4 brks: B		10
339	Quercus robur	Common Oak	250-300cm	Feathered: 3 brks: 2x: B		20
85	Salix caprea	Goat Willow	100-125cm	1+1: Transplant - seed raised: Branched: 3 brks: B		5
127	Sambucus nigra	Common Elder	80-100cm	1+1: Transplant - seed raised: Branched: 3 brks: B		7.5
42	Sorbus aucuparia	Rowan	250-300cm	Feathered: 3 brks: 2x: B		2.5
85	Taxus baccata	Common Yew	25-30cm	2+2: Transplant - seed raised: B		5
Native Screening Woodland Mix B				Total Area (m ²):	5920	■
Quantities	Species Name	Common Name	Height	General Specification		Percentage
276	Acer campestre	Common Maple	250-300cm	Feathered: 3 brks: 2x: B		7
197	Betula pendula	Common Silver Birch	250-300cm	Feathered: 3 brks: 2x: B		5
197	Carpinus betulus	Common Hornbeam	100-125cm	1+2: Transplant - seed raised: B		5
197	Cornus sanguinea	Common Dogwood	60-80cm	1+1: Transplant - seed raised: Branched: 3 brks: B		5
197	Corylus avellana	Common Hazel	80-100cm	1+2: Transplant - seed raised: Branched: 4 brks: B		5
395	Crataegus monogyna	Common Hawthorn	100-125cm	1+2: Transplant - seed raised: B		10
158	Ilex aquifolium	Common Holly	40-60cm	Leader with Lateral: C		4
118	Populus tremula	Aspen	250-300cm	Feathered: 3 brks: 2x: B		3
118	Prunus avium	Wild Cherry	250-300cm	Feathered: 3 brks: 2x: B		3
138	Prunus spinosa	Blackthorn	100-125cm	1+2: Transplant - seed raised: Branched: 4 brks: B		3.5
789	Quercus robur	Common Oak	250-300cm	Feathered: 3 brks: 2x: B		20
197	Salix caprea	Goat Willow	100-125cm	1+1: Transplant - seed raised: Branched: 3 brks: B		5
296	Salix cinerea	Grey Willow	90-120 cm	1+1: Transplant - seed raised: Branched: 3 brks: B		7.5
296	Sambucus nigra	Common Elder	80-100cm	1+1: Transplant - seed raised: Branched: 3 brks: B		7.5
79	Sorbus aucuparia	Rowan	250-300cm	Feathered: 3 brks: 2x: B		2
296	Taxus baccata	Common Yew	25-30cm	2+2: Transplant - seed raised: B		7.5
Defensible Woodland Edge Mix				Total Area (m ²):	2040	■
Quantities	Species Name	Common Name	Height	General Specification		Percentage
68	Corylus avellana	Common Hazel	60-80cm	1+2: Transplant - seed raised: Branched: 3 brks: B		5
340	Crataegus monogyna	Common Hawthorn	80-100cm	1+2: Transplant - seed raised: B		25
170	Ilex aquifolium	Common Holly	30-40cm	2L Pot, Leader with Lateral: C		12.5
170	Prunus spinosa	Blackthorn	80-100cm	1+2: Transplant - seed raised: Branched: 3 brks: B		12.5
170	Rosa canina	Dog Rose	60-80cm	1+2: Transplant - seed raised: Branched: 5 brks: B		12.5
136	Rubus fruticosus	Blackberry	40-60cm Pot, 0/1: Cutting: Branched: 2 brks: B		10	
68	Sambucus nigra	Common Elder	60-80cm	1+1: Transplant - seed raised: Branched: 3 brks: B		5
68	Viburnum opulus	Guelder Rose	80-100cm	1+2: Transplant - seed raised: Branched: 3 brks: B		5
170	Ulex europaeus	Gorse	30-40cm	Leader with Lateral: C		12.5

PROTECTION OF EXISTING VEGETATION

- Existing trees and vegetation to be retained shall be protected by fencing as set out in BS 5837:2012. Fencing shall be erected prior to commencement of construction works and maintained during building operations. Protective fencing shall be removed once construction has been completed. Refer to arboricultural survey and recommendations.

PLANTING NOTES

- Suitable non-residual contact herbicide (eg. glyphosate-based herbicide) to be applied in accordance with the manufacturer's instructions to existing sward within areas of proposed planting, to reduce competition from grasses. Herbicides should comply with the Plant Protection Products Regulations 2011 and Plant Protection Products (Sustainable Use) Regulations 2012, and be on the current HSE Pesticides Register of UK Authorised Products. Care must be taken to avoid damage to existing trees and vegetation to be retained, or pollution of adjoining water bodies. No herbicide shall be applied within areas protected by arboricultural protective fencing, or within proximity of the watercourse.
- Delivery of plant material should not be accepted until the preparatory works (above) have been completed, to minimise delay in planting and prevent loss of plants due to drought-stress, poor air circulation, lack of light, frost damage, etc.
- Plant material to conform to the National Plant Specification. Plant handling and planting operations to be in accordance with HTA 'Handling and Establishing Landscape Plants', Parts I-II

Native Screening Woodland Mix

- 40% Feathered / 60% Transplant. Transplants to be notch planted in random groups of 2 to 5 of the same species at 1.5m x 1.5m spacing to species proportions specified on the planting schedules. Feathered to be evenly planted through Woodland Mix at 3m x 3m spacing to species proportions specified on the planting schedules. Screenshot an area of 1.0m diameter around each planting location. Make a vertical 'T' notch, deep enough to accommodate the full depth of roots, within each screefed area. Plant tree/shrub within notch, backfill notch with topsoil and firm soil.

Defensible Woodland Edge Mix

- Whips and transplants to be notch planted in random groups of 3 to 7 of the same species at 1.5m x 1.5m spacing to species proportions specified on the planting schedules. Screenshot an area of 1.0m diameter around each planting location. Make a vertical 'T' notch, deep enough to accommodate the full depth of roots, within each screefed area. Plant tree/shrub within notch, backfill notch with topsoil and firm soil.

Tree shelters

- All plants to be protected using Tubex shelters or equivalent approved green or brown translucent polypropylene tubes attached to 25mm square stake. Tubes to be a minimum height of 600mm x 80mm dia. for trees and 600mm x 150mm dia for shrubs, which are openable to prevent forcing shelters over the shrub / tree canopies.

Planting

- Trees and shrubs: Late October to late March
Yew: September/October or April/May
Holly: At any time if ground and weather conditions are favourable

LANDSCAPE MANAGEMENT PLAN

Establishment and Maintenance Period (Years 1-5)

Pruning generally

- All dead, damaged or diseased tree branches shall be removed and arisings removed from site. Shrubs shall be pruned in the appropriate season to maintain health and vigour and to prevent encroachment on paths/ hard standing areas etc.
- The areas of Cornus (dogwood) and Salix (willow) shall be coppiced in year 3 to promote diverse woodland understorey structure and to enhance the effect of the coloured stems.

General

- Sufficient irrigation shall be required, especially during sustained periods of dry weather and subject to restrictions on local water supply, to ensure trees and shrubs suffer no stress. Planting areas must be wetted to field capacity.
- Weed control should continue for the first 3 years following planting, using hand weeding or herbicide application around the plant base early in the growing season, aiming to maintain an 80% weed-free area of 1.0m diameter around each tree or shrub, to ensure that tree roots become well established and young saplings grow vigorously. Care must be taken to avoid chemical or mechanical damage to tree and shrub planting.
- All tree stakes and ties shall be inspected during the growing season and adjusted as necessary to ensure that they are secure and firm and that the ties are not chaffing the stem of the trees. Stakes and ties shall be removed and disposed of when trees become self supporting, after two years and following inspection confirming this.
- Planting which fails to thrive or dies during the 5 year establishment period shall be replaced within the next suitable planting season.

Long Term Management Plan

- The areas of Cornus (dogwood) and Salix (willow) shall be coppiced on a 6 year rotation to promote structure and enhance coloured stems (50% of the areas being coppiced every 3 years in Spring).
- Thinning of trees as necessary for optimum canopy structure, by removing weakest specimens.

General

- All soft and hard landscaping shall be inspected annually by the Landscape Contractor and an approved arboriculturist and tree works carried out as necessary to ensure the continued health and safety of the trees, in accordance with the Landscape and Biodiversity Management Strategy which accompanies the planning application.

Notes:

- Cables which prevent the planting of the proposed woodland to be underground.
- Planting to be in accordance with the safety clearance zones required by the Electricity Safety, Quality and Continuity Regulations 2002.
- Reference should be made to Health and Safety Executive (HSE) Guidance Notes GS6 'Avoiding Danger from Overhead Power Lines', and HS G47 'Avoiding Danger from Underground Services' prior to commencing planting and maintenance operations.
- Services corridors must be lined with tree root barriers, where trench is within 3.0m of proposed tree planting, including structural planting. No tree planting must be allowed within services corridors. Contractor to confirm location of services corridors prior to planting.

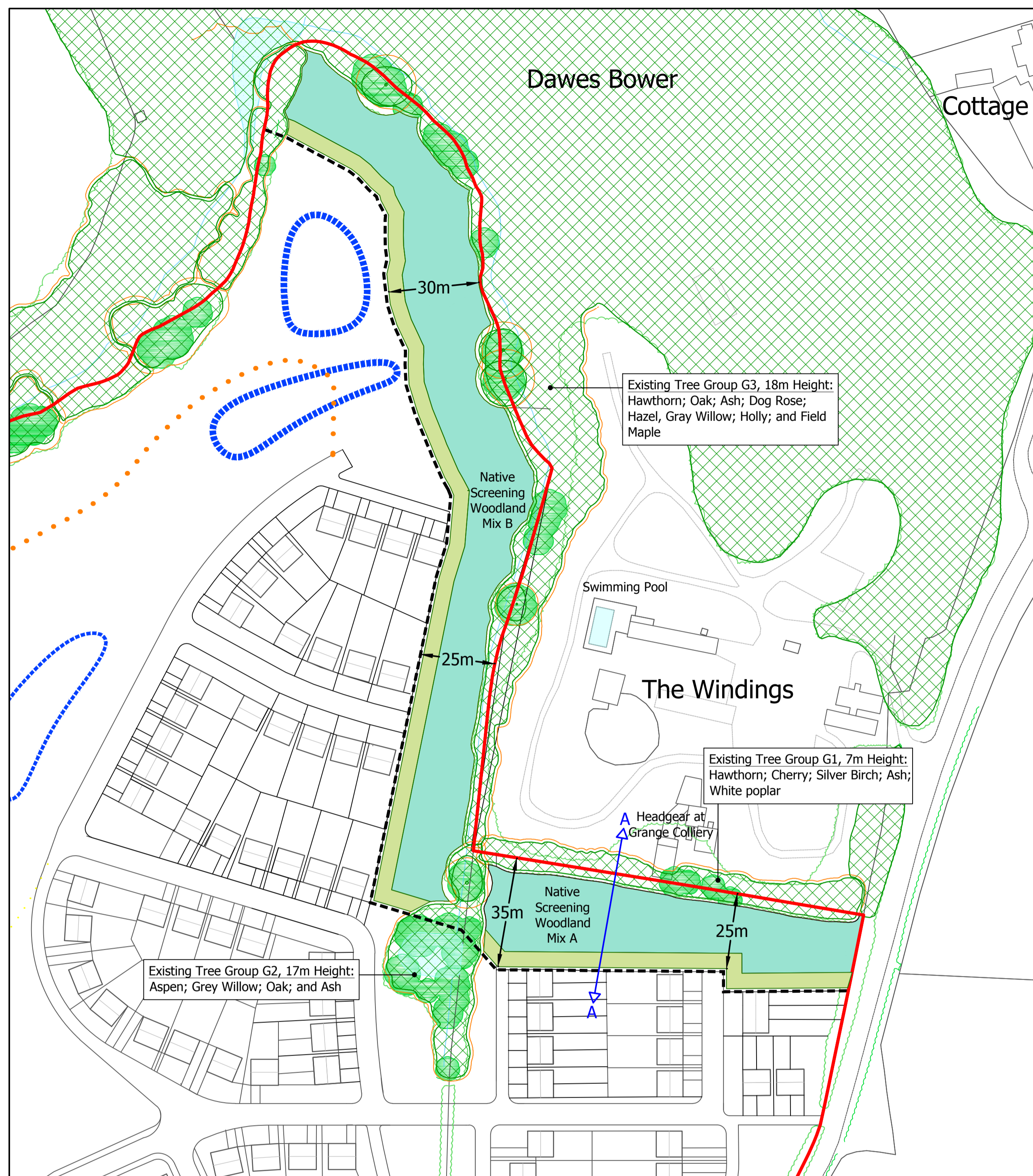

Plan

Scale: 1:1000 @ A1 / 1:2000 @ A3



Section AA

Scale 1:200 @ A1 / 1:400 @ A3

The scaling of this drawing cannot be assured

Revision _____ Date _____ Dwn _____ Ckd _____

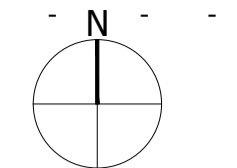

Legend

- Site Boundary
- Existing Water Courses
- Trees / Woodland **
- Root Protection Area **
- Surface water attenuation feature
- Proposed pedestrian path
- 1.2m Timber post and rail fence
- Native Screening Woodland Mix
- Defensible Woodland Edge Mix
- Existing Vegetation
- Proposed Vegetation at maturity (approx 3 - 13+ metres)
- Proposed Vegetation Year 1 (Whips / transplants 60cm-3m)

Sources:
 * OS Mapping
 ** TEP Tree Constraints Plan, Drawing number D4038.01.001, dated 24/07/13
 * Southern National Cycle Network GIS Data Set

Woodland Strategy

The proposed screening woodland will offer a ecologically sensitive native woodland belt with a species composition to complement the existing middle-aged to mature trees in groups G1, G2 and G3.

The proposed woodland will have a 20% Common Oak (Quercus robur) planting to help assimilate into Wildlife Site (OL2) immediately north of the Site and the Oak woodlands of Granville Local Nature Reserve 500m north of the Site.

The 25-35m wide vegetation belt is composed of both deciduous and evergreen species, planted at a density which will ensure no inter-visibility between the proposal and The Windings.

The vegetation belt incorporates a 5 metre wide defensible margin on the south-west edge. This strip is composed of native spiny shrubs, which will provide an impenetrable edge natural woodland margin. In addition, a continuous 1.2m high timber post and rail fence along the edge of the woodland will further deter access.

This Landscape Strategy Plan is based on the Illustrative Master Plan drawing- DWG02 - Telford Masterplan - Rev G

Project
Grange Farm, Telford
 Drawing Title
Screening Woodland Planting Plan

Date	Scale	Drawn by	Check by
22.05.2016	-	CB	ET
Project No	Drawing No	Revision	
22552	L9	B	



Planning • Master Planning & Urban Design
 Architecture • Landscape Planning & Design • Project Services
 Environmental & Sustainability Assessment • Graphic Design

bartonwillmore.co.uk

