

W2006/0608

BOROUGH OF TELFORD & WREKIN
ENVIRONMENT & REGENERATION

TURREFF AVENUE

09 MAY 2006



RECEIVED

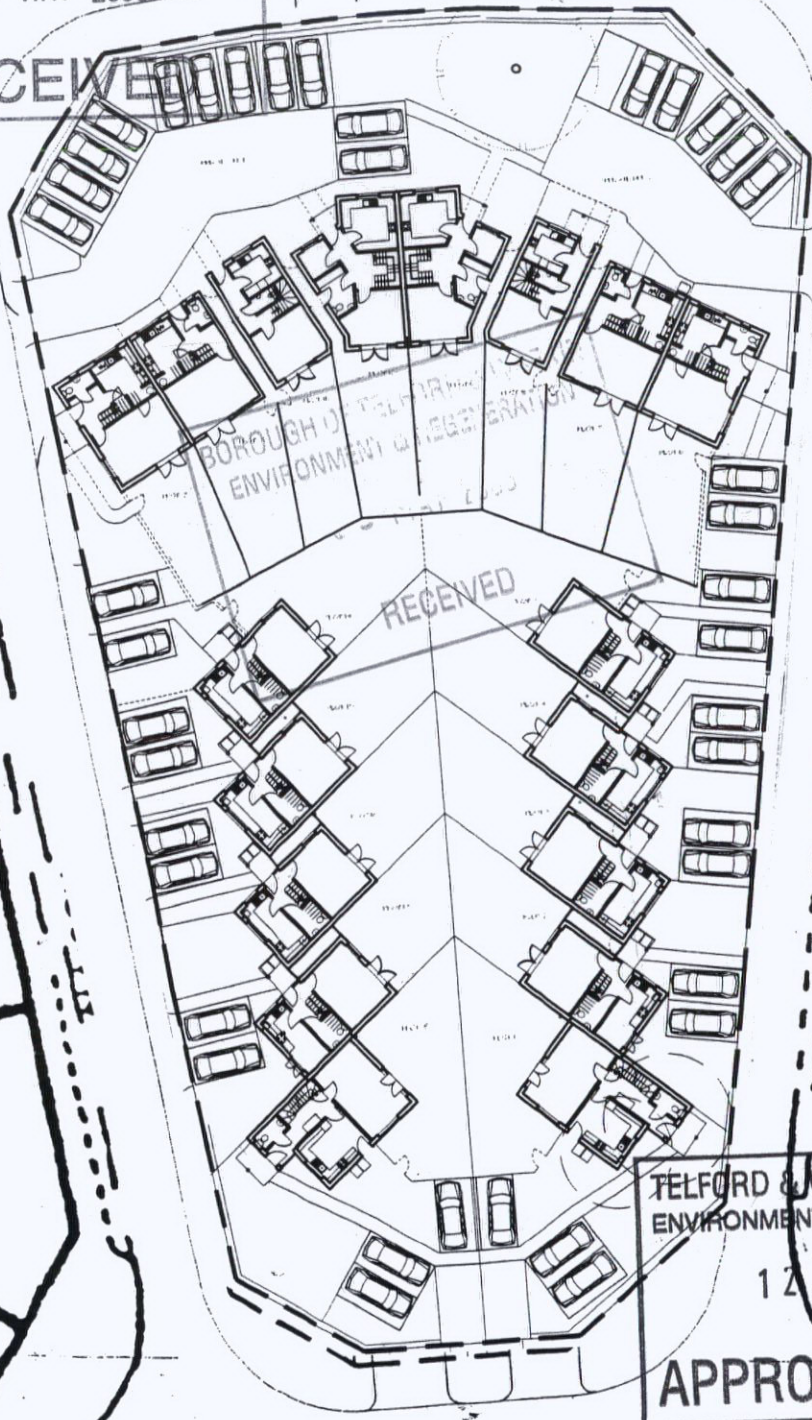

BOROUGH OF TELFORD & WREKIN
ENVIRONMENT & REGENERATION

RECEIVED

TELFORD & WREKIN COUNCIL
ENVIRONMENT & REGENERATION

12 JUL 2006

APPROVED PLAN

CHURCH WALK

15 College Hill
Shrewsbury
SY1 1LY
t. 01743 241144
f. 01743 352726
e. design@wdw.uk.com

wdw
chartered architects

DORDALE DEVELOPMENTS

Church Walk
Donnington

BLOCK PLAN

PLANNING SUBMISSION

scale: 1:500 project no: 3732 sheet no: P2.03

© The contents of this drawing are the copyright of WDW ARCHITECTS 2006

M:\env\drawings\3732 Church Walk Donnington\PLANNING - SUBMISSION.dwg