

N

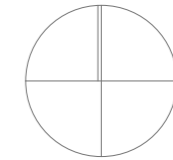

House type Key

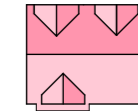

2 bedroom Affordable M4(2)
Category 2: Accessible & adaptable dwellings

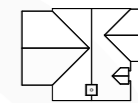

3 & 4 bedroom market dwellings.



Indicates vehicular passing place



Hatched area granted outline planning permission Ref: TWC/2015/0994.

Vehicular passing place

Private Road to be controlled by a management company

Farm track to provide vehicular access to the existing agricultural store.

The proposed development will not alter the route of the public right of way

Vehicular passing place

Vehicular access connecting into proposed vehicular access in granted outline permission.

er Lane

Communal bin store area

Cedar Lodge

S

Ordnance Survey (c) Crown Copyright 2013. All rights reserved. Licence number 100020449

SCALE BAR 1:500



base Architecture & Design Limited : Unit 1 : NEXUS : Roushill : Shrewsbury : Shropshire : SY1 1PT : T: 01743 236400 : F: 01743 236405 E: office@basearchitecture.co.uk

D	12.06.18	Vehicular passing places/ communal bin storage area added and amendment to plot 1 boundary following planning officers comments.	AT	CH
C	07.06.18	Changes in accordance with parking standards	CW	CH
B	13.02.18	Revision to red line boundary to extend up to the highway as requested by the Local Authority.	AT	CH
A	16.11.2017	Revision to layout of plot 4 & 5 following correspondances with Local Authority. Revision to layout of plot 1, 5 & 6 following correspondances with Local Authority. Revision to layout of plot 1 following correspondances with Local Authority.	AT	CH
Rev No.	Date	Rev.	By.	Chk.

PLANNING

Scale:	1:500 @ A3	Date:	Nov 2016	Drawn by:	AT	Chk.	DO
--------	------------	-------	----------	-----------	----	------	----



Project Title:	THE STACK YARD		
Client:	MR BROWN		
Drawing Title:	SITE LAYOUT		
Project No.	BA1747	Drawing No.	PL-010
		Revision:	D

base Architecture and Design is a registered Limited Company